

TOYOTA LEXUS 2005-'2007 / LEXUS LX570 '2009-'2010



1 FRONT BUMPER LX270



2 FRONT BUMPER PEARL WHITE NEW 070



3 FRONT BUMPER PEARL WHITE OLD 057



NO	CODE	DESCRIPTION	PATTERN	MODEL	YEAR	OEM	PCS	M3	N.W.	GW	PART LINK
1	TYB209 NA	FRONT BUMPER	BK	LEXUS	05-'08	52119-60928					
2	TYB209 NB	FRONT BUMPER PEARL WHITE NEW 070		LEXUS LX470	04-07	52119-60928					
3	TYB209 NW	FRONT BUMPER PEARL WHITE OLD 057		LEXUS LX470	04-07	52119-60928					

4 GRILLE LX270



5 GRILLE LEXUS LX570



6 SIDE PROTECTION MOULDING (4 PCS/SET) **SA**

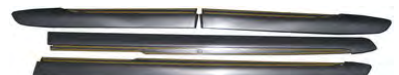

NO	CODE	DESCRIPTION	PATTERN	MODEL	YEAR	OEM	PCS	M3	N.W.	GW	PART LINK
4	TYG209 NA	GRILLE CP/GY (ORIGINAL)		LEXUS	05-'08	53101-60390/80					
5	TYG129 NA	GRILLE LEXUS LX570	CP/GY	LEXUS LX570	10-12	53101-60912/60521/31/41/51					
	TYG129 NB	GRILLE CP/WT (070)		LEXUS LX570	11-12	53101-60912					
	TYG129 NC	GRILLE ALL CP		LEXUS LX570	11-12	53101-60912					
6	TYDT129 SA	SIDE PROTECTION MOULDING (4 PCS/SET)		LEXUS LX570	'09-10	PZ329-6006-6009	1	0.0500	4.00	5.00	
	TYDT129 SB	DOOR MOULDING ASSY WITH CP SETS 4 PCS WHITE (070)		LEXUS LX570	'09-'10	PZ329-6006-6009-A0	1	0.0500	4.00	5.00	

7 DOOR MOULDING ASSY WITH CP 4 PS SETS BEIGE (4R3) **SC**



8 DOOR MOULDING ASSY WITH CP SETS BK (202) **SE**



9 DOOR MOULDING ASSY WITH CP SETS WT (040) **SW**



NO	CODE	DESCRIPTION	PATTERN	MODEL	YEAR	OEM	PCS	M3	N.W.	GW	PART LINK
7	TYDT129 SC	DOOR MOULDING ASSY WITH CP 4 PS SETS BEIGE (4R3)		LEXUS LX570	'09-'10	PZ329-6006-6009	1	0.0500	4.00	5.00	
	TYDT129 SD	DOOR MOULDING ASSY WITHCP DARK GRAY (IE9)		LEXUS LX570	'09-'10	PZ329-6006-6009	1	0.0500	4.00	5.00	
8	TYDT129 SE	DOOR MOULDING ASSY WITH CP SETS BK (202)		LEXUS LX570	09-10	PZ329-6000-6009					
9	TYDT129 SW	DOOR MOULDING ASSY WITH CP SETS WT (040)		LEXUS LX570	09-10	PZ329-6000-6009					

10 CHROME GARNISH



11 CONDENSER



NO	CODE	DESCRIPTION	PATTERN	MODEL	YEAR	OEM	PCS	M3	N.W.	GW	PART LINK
10	TYDM129 SA	LX570 SIDE PROTECTION MOULDING		LEXUS LX570	'09-10						
11	PL3607	CONDENSER		LEXUS GS300	'06-07	PL3607					

TOYOTA LEXUS LX350 2010-2011 / RX300 '2003



1 FRONT SKIRT

2 FRONT BUMPER

3 REAR BUMPER



NO	CODE	DESCRIPTION	PATTERN	MODEL	YEAR	OEM	PCS	M3	N.W.	GW	PART LINK
	TYSP349 NA	FRONT LOWER SKIRT PRIME									
1		SETS DO NOT SALE AE AND IR		LEXUS LX350	10-11	PZ321-48002	1	0.1	4.00	5.00	
2	TYB299 NA	FRONT BUMPER		LEXUS RX300	'03						
3	TYB300 NA	REAR BUMPER		LEXUS RX300	'03						

4 GRILLE

NA

5 GRILLE

NB

6 GRILLE

NC



NO	CODE	DESCRIPTION	PATTERN	MODEL	YEAR	OEM	PCS	M3	N.W.	GW	PART LINK
4	TYG299 NA	GRILLE		LEXUS RX300	'03						
5	TYG299 NB	GRILLE		LEXUS RX300	'03						
6	TYG299 NC	GRILLE		LEXUS RX300	'03						

7 HEAD LAMP

NA

8 HEAD LAMP

NB

9 FOG LAMP



NO	CODE	DESCRIPTION	PATTERN	MODEL	YEAR	OEM	PCS	M3	N.W.	GW	PART LINK
7	TYHL299 RA	HEAD LAMP RH		LEXUS RX300	'03						
	TYHL299 LA	HEAD LAMP LH		LEXUS RX300	'03						
8	TYHL299 RB	HEAD LAMP RH		LEXUS RX300	'03						
	TYHL299 LB	HEAD LAMP LH		LEXUS RX300	'03						
9	TYFL299 RA	FOG LAMP RH		LEXUS RX300	'03						
	TYFL299 LA	FOG LAMP LH		LEXUS RX300	'03						

10 SPOILER

NO	CODE	DESCRIPTION	PATTERN	MODEL	YEAR	OEM	PCS	M3	N.W.	GW	PART LINK
10	TYBL299 RA	SPOILER		LEXUS RX300	'03						
	TYBL299 LA	SPOILER		LEXUS RX300	'03						
	TYBL300 RA	SPOILER		LEXUS RX300	'03						
	TYBL300 LA	SPOILER		LEXUS RX300	'03						

TOYOTA LEXUS LX570 2012



1 FRONT BUMPER W/SENSOR HOLE **NEW!!!**



2 FRONT BUMPER FINISHER BK/GY **NEW!!!**



3 REAR BUMPER W/SENSOR HOLE **NEW!!!**

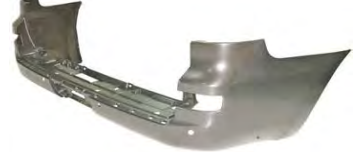

NO	CODE	DESCRIPTION	PATTERN	MODEL	YEAR	OEM	PCS	M3	N.W.	GW	PART LINK
1	TYB243 NA	FRONT BUMPER		LEXUS LX570	12	52119-6A972/60K60	1	0.06	4.50	5.00	
2	TYBF243 NA	FRONT BUMPER FINISHER BK/GY		LEXUS LX570	12	53112-60150	5	0.03	3.00	3.50	
3	TYB244 NA	REAR BUMPER W/SENSOR HOLE		LEXUS LX570	12	52159-60999 /60630	1	0.06	4.50	5.00	

4 GRILLE CP/GY/BK **NEW!!!**



5 FRONT BUMPER BRACKER **NEW!!!**



6 REAR MUD GUARD



NO	CODE	DESCRIPTION	PATTERN	MODEL	YEAR	OEM	PCS	M3	N.W.	GW	PART LINK
4	TYG243 NA	GRILLE CP/GY/BK		LEXUS LX570	12	53112-60130					
5	TYBS243 RA	FRONT BUMPER BRACKER RH		LEXUS LX570	12	52115-60180					
	TYBS243 LA	FRONT BUMPER BRACKER LH		LEXUS LX570	12	52116-60220					
6	TYMG244 RA	REAR MUD GUARD RH		LEXUS LX570	12	76625-60200					
	TYMG244 LA	REAR MUD GUARD LH		LEXUS LX570	12	76626-60200					

7 FRONT SIDE MOULDING



8 REAR SIDE MOULDING



9 DOOR MOULDING SETS CP/WT(070)



NO	CODE	DESCRIPTION	PATTERN	MODEL	YEAR	OEM	PCS	M3	N.W.	GW	PART LINK
7	TYDT243SB F RH	FRONT SIDE MOULDING RH		LEXUS LX570	12	75071-60100-A0					
	TYDT243SB FLH	FRONT SIDE MOULDING LH		LEXUS LX570	12	75072-60090-A0					
8	TYDT243SB R RH	REAR SIDE MOULDING RH		LEXUS LX570	12	75075-60100-A0					
	TYDT243SB R LH	REAR SIDE MOULDING LH		LEXUS LX570	12	75076-60100-A0					
9	TYDT243 SB	DOOR MOULDING SETS CP/WT(070)		LEXUS LX570	'11-'13	75071/72/75/76-60010/60090/100					

10 DOOR MOULDING SETS CP/BLACK (202)

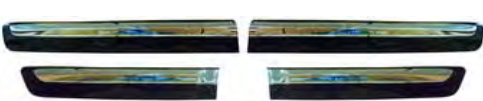

11 BUMPER COVER REAR PART BK202



12 COVER UPPER REAR BUMPER



NO	CODE	DESCRIPTION	PATTERN	MODEL	YEAR	OEM	PCS	M3	N.W.	GW	PART LINK
10	TYDT243 SE	DOOR MOULDING SETS CP/BLACK (202)		LEXUS LX570	'11-'13	75071/72/75/76-60010/60090/100					
11	TYSP244 CA	BUMPER COVER REAR PART BK202		LEXUS LX570	12	52169-60130(BK202)					
12	TYP244 UA	COVER UPPER REAR BUMPER		LEXUS LX570	12	52302-60040					

13 MOULDING BUMPER PANEL UPPER



14 FOG LAMP BASE



14 FOG LAMP COVER CP



NO	CODE	DESCRIPTION	PATTERN	MODEL	YEAR	OEM	PCS	M3	N.W.	GW	PART LINK
13	TYP244SP NA	MOULDING BUMPER PANEL UPPER		LEXUS LX570	'11-'13	TYP244SP NA					
14	TYFC243 BL	FOG LAMP BASE LH		LEXUS	12-13	52712-60020					
	TYFC243 BR	FOG LAMP BASE RH		LEXUS	12-13	52711-60020					
15	TYFC243 LA	FOG LAMP COVER LH CP		LEXUS	12-13	52128-60140					
	TYFC243 RA	FOG LAMP COVER RH CP		LEXUS	12-13	52127-60130					

TOYOTA PRADO FJ90 '1997-'1999 / FJ90 '1999-'2003



1 FRONT BUMPER W/O SPORT LAMP HOLE W/ FF HOLE



2 GRILLE VERTICLE CP/GYM NA



3 GRILLE VERTICLE BK NB



NO	CODE	DESCRIPTION	PATTERN	MODEL	YEAR	OEM	PCS	M3	N.W.	GW	PART LINK
1	52119-60900	FRONT BUMPER W/O SPORT LAMP HOLE W/ FF HOLE		PRADO VZJ95	'96-'99	52119-60900					
2	TYG069 NA	GRILLE VERTICLE	CP/GYM	PRADO FJ90	'97-'99	53111-60310	5	0.0946	7.50	10.00	
3	TYG069 NB	GRILLE VERTICLE	BK	PRADO FJ90	'97-'99	52111-60290	5	0.0946	7.50	10.00	

4 GRILLE VERTICLE NC



5 GRILLE HORIZONTAL CP/GYM NA



6 GRILLE HORIZONTAL GYM NB



NO	CODE	DESCRIPTION	PATTERN	MODEL	YEAR	OEM	PCS	M3	N.W.	GW	PART LINK
4	TYG069 NC	GRILLE VERTICLE	ALL CP	PRADO FJ90	'97-'99	53101-60310	5	0.0946	7.50	10.00	
5	TYG075 NA	GRILLE HORIZONTAL	CP/GYM	PRADO FJ90	'99-'03	53111-60380	5	0.7770	7.50	10.50	
6	TYG075 NB	GRILLE HORIZONTAL	GYM	PRADO FJ90	'99-'03		5	0.7770	7.50	10.50	

7 GRILLE HORIZONTAL NC



8 HEAD LAMP



9 CORNER LAMP



NO	CODE	DESCRIPTION	PATTERN	MODEL	YEAR	OEM	PCS	M3	N.W.	GW	PART LINK
7	TYG075 NC	GRILLE HORIZONTAL	ALL CP	PRADO FJ90	'99-'03	PERFORMANCE	5	0.7770	7.50	10.50	
8	TYHL075 RA	HEAD LAMP RH		PRADO FJ90	'99-'03	81130-6A120	4	0.1309	6.00	8.00	
	TYHL075 LA	HEAD LAMP LH		PRADO FJ90	'99-'03	81170-60840	4	0.1309	6.00	8.00	
9	TYCL075 RA	CORNER LAMP RH		PRADO FJ90	'99-'03	81521-60380	20	0.1390	8.00	10.00	
	TYCL075 LA	CORNER LAMP LH		PRADO FJ90	'99-'03	81511-60510	20	0.1390	8.00	10.00	

10 FOG LAMP



11 TAIL LAMP



NO	CODE	DESCRIPTION	PATTERN	MODEL	YEAR	OEM	PCS	M3	N.W.	GW	PART LINK
10	TYFL075 RA	FOG LAMP RH		PRADO FJ90	'99-'03	81210-60060	20	0.1602	12.00	14.00	
	TYFL075 LA	FOG LAMP LH		PRADO FJ90	'99-'03	81220-60060	20	0.1602	12.00	14.00	
11	TYL075 RA	TAIL LAMP RH		PRADO FJ90	'99-'03	81551-60600	10	0.0939	6.00	8.00	
	TYL075 LA	TAIL LAMP LH		PRADO FJ90	'99-'03	81561-60520	10	0.0939	6.00	8.00	

TOYOTA PRADO '2003 / PRADO '2005



1 GRILLE CP/GYM

NA



2 GRILLE GYM

NB



3 GRILLE CP

NC



NO	CODE	DESCRIPTION	PATTERN	MODEL	YEAR	OEM	PCS	M3	N.W.	GW	PART LINK
1	TYG071 NA	GRILLE	CP/GYM	PRADO FJ120	'03-'04	53111-60500 53101-60320	1	0.0200	1.50	2.00	
2	TYG071 NB	GRILLE	GYM	PRADO FJ120	'03-'04	53111-60490/53101-60310	1	0.0200	1.50	2.00	
3	TYG071 NC	GRILLE	CP	PRADO FJ120	'03-'04	53111-60500	1	0.0200	1.50	2.00	

4 FRONT BUMPER W/O FF & FOG LAMP HOLE

5 F. BUMPER WITH FF & FOG LAMP HOLE

6 F. BUMPER WITH FF & FOG LAMP HOLE



NO	CODE	DESCRIPTION	PATTERN	MODEL	YEAR	OEM	PCS	M3	N.W.	GW	PART LINK
4	TYB071 NA	FRONT BUMPER W/O FF & FOG LAMP HOLE		PRADO NEW	'03-'05	52119-60942	1	0.0600	6.00	8.00	
5	TYB071 NB	F. BUMPER WITH LOWER HOLE (IRAN)		PRADO NEW	'03-'05	52119-60943/60481	1	0.0500	4.00	4.50	
6	TYB071 NC	F. BUMPER WITH FF & FOG LAMP HOLE		PRADO NEW	'03-'05	52119-60933	1	0.0500	4.00	4.50	

7 REAR BUMPER

8 REAR BUMPER

9 SPOILER WHITE (056) W/ TYBL109 NA



NO	CODE	DESCRIPTION	PATTERN	MODEL	YEAR	OEM	PCS	M3	N.W.	GW	PART LINK
7	TYB072 NA	REAR BUMPER		PRADO	'05-'07	52159-60914/60220/30	1	0.06	4.50	5.00	
8	52159-60912	REAR BUMPER		PRADO	03	52159-60912	1	0.06	2.75	3.45	
9	TYBP071 NA	SPOILER WHITE (056) W/ TYBL109 NA		PRADO	'03-'05	08150-60050/60821					

10 SPOILER BLACK (202) W/ TYBL109 NA

NB

11 SPOILER DARK GRAY METALIC (1E9) W/ TYBL109 NA

NC

12 SPOILER PEARL WHITE (070) W/ TYBL109 NA

ND



NO	CODE	DESCRIPTION	PATTERN	MODEL	YEAR	OEM	PCS	M3	N.W.	GW	PART LINK
10	TYBP071 NB	SPOILER BLACK (202) W/ TYBL109 NA		PRADO	'03-'06	08150-60050/60821					
11	TYBP071 NC	SPOILER DARK GRAY METALIC (1E9) W/ TYBL109 NA		PRADO	'03-'06	08150-60050/60821					
12	TYBP071 ND	SPOILER PEARL WHITE (070) W/ TYBL109 NA		PRADO	'03-'06	08150-60050/60821					
	TYBP071 NE	SPOILER METALIC (104) W/TYBL109 NA		PRADO	03-'06	08150-60050/60821					

13 SPOILER METALIC GOLD (587 KG4) W/ TYBL109 NA

NF

14 SPOILER LAMP CLEAR

15 HEAD LAMP



NO	CODE	DESCRIPTION	PATTERN	MODEL	YEAR	OEM	PCS	M3	N.W.	GW	PART LINK
13	TYBP071 NF	SPOILER METALIC GOLD (587 KG4) W/ TYBL109 NA		PRADO	'03-'06	08150-60050/60821					
14	TYBL109 NA	SPOILER LAMP CLEAR		NEW PRADO	'05-'06		1	0.0200	0.50	0.75	
15	TYHL071 RA	HEAD LAMP RH		PRADO	'03-'05	81130-6A220					
	TYHL071 LA	HEAD LAMP LH		PRADO	'03-'05	81170-6A260/KW-06-013					

TOYOTA PRADO '2003 / PRADO '2005

1 FOG LAMP



2 FOG LAMP COVER



3 REFLECTOR BUMPER LAMP



NO	CODE	DESCRIPTION	PATTERN	MODEL	YEAR	OEM	PCS	M3	N.W.	GW	PART LINK
1	TYFL071 RA	FOG LAMP RH (UNIT / ASS'Y)		PRADO	'03-'05	81211-60150					
	TYFL071 LA	FOG LAMP LH (UNIT / ASS'Y)		PRADO	'03-'05	81221-60070					
2	TYFC071 RA	FOG LAMP COVER RH	PRADO	'05							
	TYFC071 LA	FOG LAMP COVER LH	PRADO	'05							
3	TYRL071 RA	REFLECTOR BUMPER LAMP RH		PRADO	'03-'05	81580-60111					
	TYRL071 LA	REFLECTOR BUMPER LAMP LH		PRADO	'03-'05	81590-60141					

4 TAIL LAMP



5 TAIL LAMP



NB

6 TAIL LAMP



NC

NO	CODE	DESCRIPTION	PATTERN	MODEL	YEAR	OEM	PCS	M3	N.W.	GW	PART LINK
4	TYL071 RA	TAIL LAMP RH		PRADO	'03-'05	81561-60620					
	TYL071 LA	TAIL LAMP LH		PRADO	'03-'05	81551-60700					
5	TYL071 RB	TAIL LAMP RH LED		PRADO	'03-'05	81561-60620					
	TYL071 LB	TAIL LAMP LH LED		PRADO	'03-'05	81551-60700					
6	TYB071 NB	F. BUMPER WITH LOWER HOLE (IRAN)		PRADO	'03-'05	81561-60620					
	TYL071 LC	TAIL LAMP LH		PRADO	'03-'05	81551-60700					

7 F.FENDER



8 HOOD



9 DASH BOARD COVER FOR TV



NO	CODE	DESCRIPTION	PATTERN	MODEL	YEAR	OEM	PCS	M3	N.W.	GW	PART LINK
7	53801-60850	F.FENDER RH		PRADO	'03	53801-60850					
	53802-6A150	F.FENDER LH		PRADO	'03	53802-6A150					
8	53301-60470			PRADO	'03	53301-60470					
9	TYDB071 NA			PRADO	'03-'05	55412-60250					

10 AIR FILTER



11 ENGINE FAN BLADE



12 RADIATOR KDJ / VZJ

NO	CODE	DESCRIPTION	PATTERN	MODEL	YEAR	OEM	PCS	M3	N.W.	GW	PART LINK
10	17801-30040		PRADO	'05-'09		17801-30040					
11	EFB071 TY	ENGINE FAN BLADE		PRADO, D40, SURF	'03-'05	16361-67020					
12	88461-35160	RADIATOR KDJ		PRADO	'05	88461-35160	1				
13	16400-62230	RADIATOR VZJ		PRADO	'05	16400-62230	1				

TOYOTA PRADO '2010



1 FRONT BUMPER

2 FRONT BUMPER PEARL WHITE 070

3 REAR BUMPER



NO	CODE	DESCRIPTION	PATTERN	MODEL	YEAR	OEM	PCS	M3	N.W.	GW	PART LINK
1	TYB271 NA	FRONT BUMPER		PRADO	09-10	52119-60928/6A920/900	1				
2	TYB271 NW	FRONT BUMPER PEARL WHITE 070		PRADO	'09-'10	52119-60928/6A920					
3	TYB272 NA	REAR BUMPER		PRADO	09-10	52159-60970	1	0.0600	4.00	4.50	

4 GRILLE

5 GRILLE ALL CP

NC

6 FOG LAMP



NO	CODE	DESCRIPTION	PATTERN	MODEL	YEAR	OEM	PCS	M3	N.W.	GW	PART LINK
4	TYG271 NA	GRILLE	CP/BK/GYM	PRADO	2010	53101-60670	1				
5	TYG271 NC	GRILLE ALL CP		PRADO	2010	53101-60670					
6	TYFL271 RA	FOX LAMP RH W/WIRE SET		PRADO	09-10	81210-0D040					
	TYFL271 LA	FOX LAMP LH W/WIRE SET		PRADO	09-10	81220-0D040					

7 HEAD LAMP

8 HEAD LAMP ELECTRIC

9 TAIL LAMP



NO	CODE	DESCRIPTION	PATTERN	MODEL	YEAR	OEM	PCS	M3	N.W.	GW	PART LINK
7	TYHL271 RA	HEAD LAMP RH		PRADO	09-10	81130-42360					
	TYHL271 LA	HEAD LAMP LH		PRADO	09-10	81170-42360					
8	TYHL271 LB	HEAD LAMP LH ELECTRIC		PRADO	09-11						
	TYHL271 RB	HEAD LAMP RH ELECTRIC		PRADO	09-11						
9	TYL271 RA	TAIL LAMP RH		PRADO	09-10	81551-42090	4	0.2312	7.00	9.00	
	TYL271 LA	TAIL LAMP LH		PRADO	09-10	81561-42090	4	0.2312	7.00	9.00	

10 REFLECTOR TAIL LAMP

11 HOOD MOULDING



NO	CODE	DESCRIPTION	PATTERN	MODEL	YEAR	OEM	PCS	M3	N.W.	GW	PART LINK
10	TYRL271 RA	REFLECTOR TAIL LAMP RH		PRADO	09-'10						
	TYRL271 LA	REFLECTOR TAIL LAMP LH		PRADO	09-'10						
11	TYHM271 NA	HOOD MOULDING ALL CP	ALL CP	PRADO	2010	75770-60010/20/30	1				

TOYOTA PRADO 2013-2014



1 FRONT BUMPER BK



2 FRONT BUMPER FINISHER



3 BUMPER FINISHER



NO	CODE	DESCRIPTION	PATTERN	MODEL	YEAR	OEM	PCS	NW	GW	M3	PART LINK
1	52119-60A60	FRONT BUMPER BK	OEM	PRADO	'14	52119-60A60					
2	TYB273 NA	FRONT BUMPER W/ FINISHER		PRADO	'14	52119-60A60					
3	TYBF273 NA	BUMPER FINISHER		PRADO	'14						

4 GRILLE CP/BK



5 HOOD MOULDING CP/BK



NO	CODE	DESCRIPTION	PATTERN	MODEL	YEAR	OEM	PCS	NW	GW	M3	PART LINK
4	TYG273 NA	GRILLE CP/BK		PRADO	'14	53111-60A60	1	2.00	2.50	0.0300	
	TYG273 NB	GRILLE BK		PRADO	'14		1	2.00	2.50	0.0300	
	TYG273 NC	GRILLE ALL CP		PRADO	'14		1	2.00	2.50	0.0300	
	TYG273 ND	GRILLE CP/CP/SVN		PRADO	'14	53111-60A60	1	2.00	2.50	0.0300	
5	TYHM273 NA	HOOD MOULDING CP/BK		PRADO	'14	75700-60040					
	TYHM273 NB	HOOD MOULDING BK		PRADO	'14						

TOYOTA RAV 4 '1994-'1997



1 FRONT BUMPER

2 GRILLE MAT BK

NA

3 GRILLE ALL CP

NC



NO	CODE	DESCRIPTION	PATTERN	MODEL	YEAR	OEM	PCS	M3	N.W.	GW	PART LINK
1	TYB095 NA	F.BUMPER EXTENSIONS	BK	RAV 4	'96-'97	52119-42011	5	0.4000	20.00	22.00	
2	TYG095 NA	GRILLE MAT BK		RAV 4	'96-'97	53111/53101-42010A	5	0.0700	4.00	5.00	
3	TYG095 NC	GRILLE ALL CP		RAV 4	'96-'97	PERFORMANCE	5	0.0700	4.00	5.00	

4 HEAD LAMP '94

5 FRONT LAMP YELLOW

R/LA A

6 FRONT LAMP WHITE

R/LB A



NO	CODE	DESCRIPTION	PATTERN	MODEL	YEAR	OEM	PCS	M3	N.W.	GW	PART LINK
4	TYHL095 RA	HEAD LAMP RH		RAV4	'94	81110-42041					
	TYHL095 LA	HEAD LAMP LH		RAV4	'94	81150-42041					
5	TYFL095 RA	FRONT LAMP RH	YELLOW	RAV4	'94	81510-42010					
	TYFL095 LA	FRONT LAMP LH	YELLOW	RAV4	'94	81520-42010					
6	TYFL095 RC	FRONT LAMP RH	WHITE	RAV4	'94	81510-42010					
	TYFL095 LC	FRONT LAMP LH	WHITE	RAV4	'94	81520-42010					

7 TAIL LAMP '94

8 DOOR MIRROR

9 RADIATOR SUPPORT '96-'01



NO	CODE	DESCRIPTION	PATTERN	MODEL	YEAR	OEM	PCS	M3	N.W.	GW	PART LINK
7	TYL095 RA	TAIL LAMP RH		RAV4	'94	81550-42010					
	TYL095 LA	TAIL LAMP LH		RAV4	'94	81560-42010					
8	TYMR095 LA	DOOR MIRROR LH		RAV4	94-98						
	TYMR095 RA	DOOR MIRROR RH		RAV4	94-98						
9	53201-42011	RADIATOR SUPPORT		RAV 4	'96-'01	53201-42011	1	0.0000	0.00	0.00	

10 MUD FLAP SETS W/O HOLE 4DOOR

11 MUD FLAP SETS W/LFFT HOLE 2DOOR

12 MUD FLAP REAR



NO	CODE	DESCRIPTION	PATTERN	MODEL	YEAR	OEM	PCS	M3	N.W.	GW	PART LINK
10	TYMG095 SA	MUD FLAP SETS W/O HOLE 4 DOOR		RAV 4	'95-'99		4	0.0500	4.00	5.00	
11	TYMG095 SB	MUD FLAP SETS W/ LEFT HOLE 2 DOOR		RAV 4	'95-'99		4	0.0500	4.00	5.00	
12	TYMG095R LA	MUD FLAP REAR LH		RAV 4	95-99						
	TYMG095R RA	MUD FLAP REAR RH		RAV 4	95-99						

TOYOTA RAV 4 '1994-'1997

1 CON DENSER



NO	CODE	DESCRIPTION	PATTERN	MODEL	YEAR	OEM	PCS	M3	N.W.	GW	PART LINK
1		CONDENSER		RAV4	'94-'95 '01-'03						

TOYOTA RAV 4 '1998-'2000



1 GRILLE



2 FRONT BUMPER



3 HEAD LAMP '98

R/LA A



NO	CODE	DESCRIPTION	PATTERN	MODEL	YEAR	OEM	PCS	M3	N.W.	GW	PART LINK
1	TYG096 NA	GRILLE		RAV4	'98						
2	TYB096 NA	FRONT BUMPER		RAV4	'98						
3	TYHL096 RA	HEAD LAMP		RAV4	'98	81110-42090					
	TYHL096 LA	HEAD LAMP		RAV4	'98	81150-42090					

4 HEAD LAMP '98

R/LC A



5 FRONT LAMP WHITE

R/LA A



6 FRONT LAMP YELLOW

R/LB A



NO	CODE	DESCRIPTION	PATTERN	MODEL	YEAR	OEM	PCS	M3	N.W.	GW	PART LINK
4	TYHL096 RC	HEAD LAMP	CRYSTAL	RAV4	'98						
	TYHL096 LC	HEAD LAMP	CRYSTAL	RAV4	'98						
5	TYFL096 RA	FRONT LAMP	WHITE	RAV4	'98	81510-42040					
	TYFL096 LA	FRONT LAMP	WHITE	RAV4	'98	81520-42040					
6	TYFL096 RB	FRONT LAMP	YELLOW	RAV4	'98	81510-42020					
	TYFL096 LB	FRONT LAMP	YELLOW	RAV4	'98	81520-42020					

7 TAIL LAMP

R/LA A



8 TAIL LAMP LED

R/LD A



NO	CODE	DESCRIPTION	PATTERN	MODEL	YEAR	OEM	PCS	M3	N.W.	GW	PART LINK
7	TYL096 RA	TAIL LAMP		RAV4	'98	81550-42050					
	TYL096 LA	TAIL LAMP		RAV4	'98	81561-42050					
8	TYL096 RD	TAIL LAMP	LED	RAV4	'98						
	TYL096 LD	TAIL LAMP	LED	RAV4	'98						

TOYOTA RAV 4 '2001-'2003



1 GRILLE CP/BK

NA

2 GRILLE BK

NB

3 GRILLE ALL CP

NC



NO	CODE	DESCRIPTION	PATTERN	MODEL	YEAR	OEM	PCS	M3	N.W.	GW	PART LINK
1	TYG094 NA	GRILLE CP/BK	CP/BK	TOYOTA RAV 4	'99-'01	53101-42110	5	0.0350	2.50	3.00	TO1200238
2	TYG094 NB	GRILLE BK	BK	TOYOTA RAV 4	'99-'02	53101-42100	5	0.0500	2.50	3.00	
3	TYG094 NC	GRILLE ALL CP	ALL CP	TOYOTA RAV 4	'99-'02	53101-42110	5	0.0350	2.50	3.00	

4 F.BUMPER '02

5 HEAD LAMP AMBER

R/LA A

6 HEAD LAMP CLEAR

R/LB A



NO	CODE	DESCRIPTION	PATTERN	MODEL	YEAR	OEM	PCS	M3	N.W.	GW	PART LINK
4	TYB097 NA	F. BUMPER W/O HOLE		TOYOTA RAV 4	'02	52119-42910	1	0.3000	15.00	16.00	
	TYB097 NB	F. BUMPER W/ HOLE		TOYOTA RAV 4	'02	52119-42911	1	0.3000	15.00	16.00	
5	TYHL094 RA	HEAD LAMP RH	AMBER	RAV4	'01-'03	81110-42190	1				
	TYHL094 LA	HEAD LAMP LH	AMBER	RAV4	'01-'03	81150-42190	1				
6	TYHL094 RB	HEAD LAMP RH	CLEAR	RAV4	'01-'03	81110-42220	1				
	TYHL094 LB	HEAD LAMP LH	CLEAR	RAV4	'01-'03	81150-42220	1				

7 HEAD LAMP '01-'03

OEM

8 HEAD LAMP '02

9 FRONT LAMP UPPER



NO	CODE	DESCRIPTION	PATTERN	MODEL	YEAR	OEM	PCS	M3	N.W.	GW	PART LINK
7	81110-42150	HEAD LAMP RH	OEM	TOYOTA RAV 4	'01-'03	81110-42150	1	0.0400	3.00	5.00	
	81150-42150	HEAD LAMP LH	OEM	TOYOTA RAV 4	'01-'03	81150-42150	1	0.0400	3.00	5.00	
8	TYHL193 RA	HEAD LAMP RH		RAV4	'02	81105-42270	1				
	TYHL193L A	HEAD LAMP LH		RAV4	'02	81106-42270	1				
9	TYFL094 RA	FRONT LAMP RH UPPER		TOYOTA RAV 4	'01-'03	81511-42060	1				
	TYFL094 LA	FRONT LAMP LH UPPER		TOYOTA RAV 4	'01-'03	81521-42060	1				

10 FOG LAMP LOWER

11 TAIL LAMP '01-03

12 TAIL LAMP '02



NO	CODE	DESCRIPTION	PATTERN	MODEL	YEAR	OEM	PCS	M3	N.W.	GW	PART LINK
10	TYFC094 RA	FOG LAMP RH LOWER		TOYOTA RAV 4	'01-'03	82211-42020	1	0.0400	3.00	5.00	
	TYFC094 LA	FOG LAMP LH LOWER		TOYOTA RAV 4	'01-'03	82221-42020	1	0.0400	3.00	5.00	
11	TYL094 RA	TAIL LAMP RA		TOYOTA RAV 4	'01-'03	81551-42060	1	0.0400	3.00	5.00	
	TYL094 LA	TAIL LAMP LH		TOYOTA RAV 4	'01-'03	81561-42060	1	0.0400	3.00	5.00	
12	TYL193 RA	TAIL LAMP RH		RAV4	'02	81551-42040	1				
	TYL193 LA	TAIL LAMP LH		RAV4	'02	81561-42040	1				

TOYOTA RAV 4 '2001-'2003

1 FENDER W/O FLARE

NA

2 FENDER W/ SIDE LAMP HOLE

NB

3 RADIATOR SUPPORT

NC



NO	CODE	DESCRIPTION	PATTERN	MODEL	YEAR	OEM	PCS	M3	N.W.	GW	PART LINK
1	53811-42150	FENDER RH W/O FLARE		TOYOTA RAV 4	'01-'03	53811-42150	1	0.0000	0.00	0.00	
	53812-42140	FENDER LH W/O FLARE		TOYOTA RAV 4	'01-'03	53812-42140	1	0.0000	0.00	0.00	
2		FENDER RH W/ SIDE LAMP HOLE		TOYOTA RAV 4	01-'03		1				
	53812-42150	FENDER LH W/ SIDE LAMP HOLE		TOYOTA RAV 4	01-'03	53812-42150	1	0.1038	2.30	3.10	
3	53201-42050	RADIATOR SUPPORT		TOYOTA RAV 4	'01-'03	53201-42050	1	0.0000	0.00	0.00	

TOYOTA RAV 4 '2006-'2009



1 GRILLE BK

NA

2 GRILLE ALL CP

NC

3 GRILLE CLAPPING ALL CP



NO	CODE	DESCRIPTION	PATTERN	MODEL	YEAR	OEM	PCS	M3	N.W.	GW	PART LINK
1	TYG195 NA	GRILLE BK		RAV 4	06-'07	53101-42150					
	TYG195 NB	GRILLE CP/BK		RAV 4	06-'07	53101-42160					
2	TYG195 NC	GRILLE ALL CP		RAV 4	06-'07	53101-42170					
3	TYGM295 NA	GRILLE CLAPPING ALL CP		RAV 4	'09-'10						

4 FRONT BUMPER

5 HEAD LAMP '05

6 FOG LAMP '06-'09



NO	CODE	DESCRIPTION	PATTERN	MODEL	YEAR	OEM	PCS	M3	N.W.	GW	PART LINK
4	TYB195 NA	FRONT BUMPER		RAV 4	06-'07						
5	TYHL195 RA	HEAD LAMP RH		RAV4	06-'09	81130-42360					
	TYHL195 LA	HEAD LAMP LH		RAV4	06-'09	81170-42360					
6	TYFL195 RA	FOG LAMP RH		RAV4	06-'09	81210-0D040					
	TYFL195 LA	FOG LAMP LH		RAV4	06-'09	81220-0D040					

7 TAIL LAMP '06-'09

8 MUD FLAP FRONT

MUD FLAP REAR

9 MUD FLAP FRONT

MUD FLAP REA



NO	CODE	DESCRIPTION	PATTERN	MODEL	YEAR	OEM	PCS	M3	N.W.	GW	PART LINK
7	TYL195 RA	TAIL LAMP RH		RAV4	06-'09	81551-42090					
	TYL195 LA	TAIL LAMP LH		RAV4	06-'09	81551-42090					
8	TYMG094 F RA	MUD FLAP FRONT LH		RAV4	'99-'02	76621-42070					
	TYMG094 F LA	MUD FLAP FRONT LH		RAV4	'99-'02	76622-42070					
	TYMG094 R RA	MUD FLAP REAR RH		RAV4	'99-'02	76625-42080					
	TYMG094 R LA	MUD FLAP REAR LH		RAV4	'99-'02	76626-42140					
9	TYMG195 F RA	MUD FLAP FRONT RH		RAV4	'06	76621-42090					
	TYMG195 F LA	MUD FLAP FRONT LH		RAV4	'06	76622-42090					
	TYMG195 R RA	MUD FLAP REAR RH		RAV4	'06	76625-42130					
	TYMG195 R LA	MUD FLAP REAR LH		RAV4	'06	76626-42190					

10 FR EXTENSION BUMPER



NO	CODE	DESCRIPTION	PATTERN	MODEL	YEAR	OEM	PCS	M3	N.W.	GW	PART LINK
10	TYPF094 RA	FR EXTENSION BUMPER RH		RAV4	'99-'02	52112-42050-CO					
	TYPF094 LA	FR EXTENSION BUMPER LH		RAV4	'99-'02	52113-42050-CO					

TOYOTA RAV 4 '2009



1 FRONT BUMPER



2 REAR BUMPER



3 GRILLE



NO	CODE	DESCRIPTION	PATTERN	MODEL	YEAR	OEM	PCS	M3	N.W.	GW	PART LINK
1	TYB295 NA	FRONT BUMPER W/O F.F. HOLE		RAV 4	'09						
	TYB295 NB	FRONT BUMPER W F.F. HOLE		RAV 4	'09						
2	TYB296 NA	REAR BUMPER		RAV 4	'09						
3	TYG295 NA	GRILLE		RAV 4	'08		1	0.0398	1.10	1.58	

4 GRILLE BK



5 HEAD LAMP



6 FOG LAMP



NO	CODE	DESCRIPTION	PATTERN	MODEL	YEAR	OEM	PCS	M3	N.W.	GW	PART LINK
4	TYG295 NB	GRILLE BK		RAV 4	'08-'09	53111-A2130					
	TYGM295 NA	GRILLE CLAPPING		RAV 4	'09-'10						
5	TYHL295 LA	HEAD LAMP LH		RAV 4	'09						
	TYHL295 RA	HEAD LAMP RH		RAV 4	'09						
6	TYFL295 RA	FOG LAMP RH		RAV 4	'09						
	TYFL295 LA	FOG LAMP LH		RAV 4	'09						

7 TAIL LAMP



8 RADIATOR SUPPORT



9 FRONT BUMPER SUPPORT



10 REAR BUMPER SUPPORT



NO	CODE	DESCRIPTION	PATTERN	MODEL	YEAR	OEM	PCS	M3	N.W.	GW	PART LINK
7	TYL295 LA	TAIL LAMP LH		RAV 4	'09						
	TYL295 RA	TAIL LAMP RH		RAV 4	'09						
8	TYR295 NA	RADIATOR SUPPORT		RAV 4	'09						
9	TYBR295 NA	FRONT BUMPER SUPPORT		RAV 4	'09						
10	TYBR296 NA	REAR BUMPER SUPPORT		RAV 4	'09						

11 FRONT GUARD



NO	CODE	DESCRIPTION	PATTERN	MODEL	YEAR	OEM	PCS	M3	N.W.	GW	PART LINK
11	TYFG295 NA	FRONT BUMPER GUARD		RAV 4	'09						

TOYOTA RAV 4 '2010-2012



1 FRONT BUMPER

2 REAR BUMPER

3 FRONT BUMPER LOWER GUARD



NO	CODE	DESCRIPTION	PATTERN	MODEL	YEAR	OEM	PCS	M3	N.W.	GW	PART LINK
1	TYB301 NA	FRONT BUMPER		RAV4	'10-'12	52119-0R040					
2	TYB302 NA	REAR BUMPER		RAV4	'10-'12	52159-0P030					
3	TYP301 NA	FRONT BUMPER LOWER GUARD		RAV4	'10-'12						

4 GRILLE

5 GRILLE MOULDING UPPER /LOWER

6 GRILLE MOULDING LEFT / RIGHT



NO	CODE	DESCRIPTION	PATTERN	MODEL	YEAR	OEM	PCS	M3	N.W.	GW	PART LINK
4	TYG301 NA	GRILLE		RAV4	'10-'12						
5	TYGM301 UA	GRILLE MOULDING UPPER		RAV4	'10-'12	53122-0R040					
	TYGM301 NA	GRILLE MOULDING LOWER		RAV4	'10-'12						
6	TYGM301 LA	GRILLE MOULDING (LEFT)		RAV4	'10-'12						
	TYGM301 RA	GRILLE MOULDING (RIGHT)		RAV4	'10-'12						

TOYOTA RAV 4 '2013-2014



1 FRONT BUMPER UPPER

2 FRONT BUMPER LOWER

3 FRONT BUMPER FINISHER



NO	CODE	DESCRIPTION	PATTERN	MODEL	YEAR	OEM	PCS	M3	N.W.	GW	PART LINK
1	TYB303 UA	FRONT BUMPER UPPER		RAV4	'13-'14						
2	TYB303 LA	FRONT BUMPER LOWER		RAV4	'13-'14						
3	TYBF303 NA	FRONT BUMPER FINISHER		RAV4	'13-'14						

4 FRONT BUMPER STRIP

5 REAR BUMPER

6 GRILLE (R / L)



NO	CODE	DESCRIPTION	PATTERN	MODEL	YEAR	OEM	PCS	M3	N.W.	GW	PART LINK
4	TYBS303 NA	FRONT BUMPER STRIP		RAV4	'13-'14	GG140-00300/310	1				
5	TYB304 NA	REAR BUMPER		RAV4	'13-'14	52159-42190	1				
6	TYG303 RA	GRILLE RH		RAV4	'13-'14	53106-42010					
	TYG303 LA	GRILLE LH		RAV4	'13-'14	53105-42010					

7 FOG LAMP SET

8 FOG LAMP

9 FOG LAMP BASE



NO	CODE	DESCRIPTION	PATTERN	MODEL	YEAR	OEM	PCS	M3	N.W.	GW	PART LINK
7	TYFL303 SA	FOG LAMP SET		RAV4	'13-'14						
5	TYFL303 RA	FOG LAMP RH		RAV4	'13-'14	81210-60180					

TOYOTA TOWNACE 1996-2002



1 GRILLE MAT GY



2 HEAD LIGHT DOOR



3 CORNER LAMP



NO	CODE	DESCRIPTION	PATTERN	MODEL	YEAR	OEM	PCS	M3	N.W.	GW	PART LINK
1	TYG311 NA	GRILLE MAT GY		TOWNACE	96-02						
2	TYD311 LA	HEAD LIGHT DOOR LH		TOWNACE	96-02	53132-28030					
	TYD311 RA	HEAD LIGHT DOOR RH		TOWNACE	96-02	53131-28030					
3	TYCL311 LA	CORNER LAMP LH		TOWNACE	96-02	81521-28190					
	TYCL311 RA	CORNER LAMP RH		TOWNACE	96-02	81511-28190					

TOYOTA TOWNACE 1998



1 FRONT BUMPER (RU)

2 GRILLE MAT GY (RU)

3 HEAD LAMP (RU)



NO	CODE	DESCRIPTION	PATTERN	MODEL	YEAR	OEM	PCS	M3	N.W.	GW	PART LINK
1	TYB313 NA	FRONT BUMPER (RU)		TOWNACE NOAH	96-98						
2	TYG313 NA	GRILLE MAT GY (RU)		TOWNACE NOAH	96-98						
3	TYHL313 LA	HEAD LAMP LH (RU)		TOWNACE NOAH	96-98						
	TYHL313 RA	HEAD LAMP RH (RU)		TOWNACE NOAH	96-98						

4 CORNER LAMP (RU)

5 FOG LAMP (RU)



NO	CODE	DESCRIPTION	PATTERN	MODEL	YEAR	OEM	PCS	M3	N.W.	GW	PART LINK
4	TYCL313 LA	CORNER LAMP LH (RU)		TOWNACE NOAH	96-98						
	TYCL313 RA	CORNER LAMP RH (RU)		TOWNACE NOAH	96-98						
5	TYFL313 LA	FOG LAMP LH (RU)		TOWNACE NOAH	96-98						
	TYFL313 RA	FOG LAMP RH (RU)		TOWNACE NOAH	96-98						

TOYOTA TOWNACE 2001 - 2004



1 HEAD LAMP CLEAR (KE,TZ,MW,MZ)



2 HEAD LAMP BK RIM (KE,TZ,MW,MZ)



3 CORNER LAMP (KE,TZ,MW,MZ)



NO	CODE	DESCRIPTION	PATTERN	MODEL	YEAR	OEM	PCS	M3	N.W.	GW	PART LINK
1	TYHL315 LA	HEAD LAMP CLEAR LH (KE,TZ,MW,MZ)		TOWNACE	01-04						
	TYHL315 RA	HEAD LAMP CLEAR RH (KE,TZ,MW,MZ)		TOWNACE	01-04						
2	TYHL315 LB	HEAD LAMP BK RIM LH (KE,TZ,MW,MZ)		TOWNACE	01-04						
	TYHL315 RB	HEAD LAMP BK RIM RH (KE,TZ,MW,MZ)		TOWNACE	01-04						
3	TYCL315 LA	CORNER LAMP LH (KE,TZ,MW,MZ)		TOWNACE	01-04						
	TYCL315 RA	CORNER LAMP RH (KE,TZ,MW,MZ)		TOWNACE	01-04						

4 FOG LAMP (KE,TZ,MW,MZ)



NO	CODE	DESCRIPTION	PATTERN	MODEL	YEAR	OEM	PCS	M3	N.W.	GW	PART LINK
4	TYFL315 LA	FOG LAMP LH (KE,TZ,MW,MZ)		TOWNACE	01-04						
	TYFL315 RA	FOG LAMP RH (KE,TZ,MW,MZ)		TOWNACE	01-04						

TOYOTA DYNA BU 30,BU40,BU41,BU60 TRUCK '1981-'1984 / '1984-'1990



1 GRILLE '81-'84 BU31,41

2 GRILLE '81-'84 BU40.41

3 GRILLE LOWER '84-'90 BU60,62



NO	CODE	DESCRIPTION	PATTERN	MODEL	YEAR	OEM	PCS	M3	N.W.	GW	PART LINK
1	TYG027 LA	GRILLE	SV/GYM	BU31,41	'81-'84	53113-39045	5	0.0557	4.00	5.50	
	TYG027 RA	GRILLE	SV/GYM	BU31,41	'81-'84	53112-39035	5	0.0557	4.00	5.50	
2	TYG029 CA	GRILLE	GYM	BU40.41	'81-'84	53111-39025	5	0.0165	2.00	3.00	
3	TYG023 DA	GRILLE LOWER	SV/BK	BU60,62 2WIPER	'84-'90	53111-95412	5	0.1097	5.00	7.50	

4 GRILLE UPPER '84-'90 BU60,62

5 GRILLE UPPER '87-'90 BU85 3 WIPER

6 GRILLE LOWER '81-'84 BU85 3 WIPER

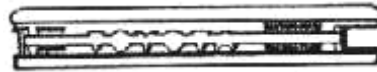

NO	CODE	DESCRIPTION	PATTERN	MODEL	YEAR	OEM	PCS	M3	N.W.	GW	PART LINK
4	TYG024 NA	GRILLE UPPER	SV/BK	BU60,62 2WIPER	'84-'90	53141-95402	5	0.0729	5.50	8.50	
5	TYG025 NA	GRILLE UPPER	SV/BK	BU85 3 WIPER	'87-'90	53105-95401	5	0.1400	8.00	10.00	
6	TYG026 NA	GRILLE LOWER	SV/BK	BU85 3 WIPER	'87-'90	53111-95413	5	0.1400	8.00	10.00	

7 S.CORNER '81-'84 BU30

8 S.CORNER '84-'90 BU60 9 ROOM MIRROR

10 CORNER LAMP DYNA BU30



NO	CODE	DESCRIPTION	PATTERN	MODEL	YEAR	OEM	PCS	M3	N.W.	GW	PART LINK
7	TYC027 LA	S.CORNER ABS/GY LH	GYM	BU30	'81-'84	55071-95404	50	0.0949	8.00	10.00	
	TYC027 RA	S.CORNER ABS/GY RH	GYM	BU30	'81-'84	55071-95407	50	0.0949	8.00	10.00	
8	TYC023 LA	S.CORNER PP/BK LH	MAT/BK	BU60	'84-'90	53113-95403	20	0.0754	10.00	12.00	
	TYC023 RA	S.CORNER PP/BK RH	MAT/BK	BU60	'84-'90	53112-95401	20	0.0754	10.00	12.00	
9	TYRM027 NA	ROOM MIRROR		DYNA BU20							
10	TYCL027 LA	CORNER LAMP LH		DYNA BU30	'81-'84	81520-39285	50	0.0600	8.00	10.00	
	TYCL027 RA	CORNER LAMP RH		DYNA BU30	'81-'84	81510-39285	50	0.0600	8.00	10.00	

11-12 CORNER LAMP DYNA '95-'98

13 TAIL LAMP DYNA BU3000

14 TAIL LAMP BU20/60



<< UPPER : LOWER >>



NO	CODE	DESCRIPTION	PATTERN	MODEL	YEAR	OEM	PCS	M3	N.W.	GW	PART LINK
11	TYCL028 LA	CORNER LAMP LOVER LH		DYNA	'95-'98	81520-37050					
	TYCL028 RA	CORNER LAMP LOVER RH		DYNA	'95-'98	81510-37050					
12	TYCL029 LA	CORNER LAMP UPPER LH		DYNA	'95-'98	81620-37030					
	TYCL029 RA	CORNER LAMP UPPER RH		DYNA	'95-'98	81610-37030					
13	TYL027 LA	TAIL LAMP LH		DYNA BU3000	'81-'84	81560-39106	10	0.0700	8.00	10.00	
	TYL027 RA	TAIL LAMP RH		DYNA BU3000	'81-'84	81550-39126	10	0.0700	8.00	10.00	
14	TYL023 LA	TAIL LAMP LH		BU20/60	'81-'90	81560-39435	20	0.0700	8.00	10.00	
	TYL023 RA	TAIL LAMP RH		BU20/60	'81-'90	81550-39465	20	0.0700	8.00	10.00	
	TYLZ023 RA	TAIL LAMP LENS RH		DYNA BU 60		81551-39465					
	TYLZ023 LA	TAIL LAMP LENS LH		DYNA BU 60		81561-39435					

TOYOTA TUNDRA 2012



1 GRILLE CP/SYG

NA

2 GRILL ALL CP W/O BIG BRACKET R/L

N

3 GRILL CP/SV/BK COMPLETE SETS WITH ALL BRACKET

SA



NO	CODE	DESCRIPTION	PATTERN	MODEL	YEAR	OEM	PCS	M3	N.W.	GW	PART LINK
1	TYG345 NA	GRILLE CP/SYG		TUNDRA	12-13	53100-0C250/53111-0C180					
2	TYG345 NB	GRILL ALL CP W/O BIG BRACKET R/L TUNDRA			'12-'13	53100-0C250					
3	TYG345 SA	GRILL CP/SV/BK COMPLETE SETS W TUNDRA ALL BRACKET			'12-'13	53100-0C250					

4 GRILL ALL CP COMPLETE SETS WITH ALL BRACKET



NO	CODE	DESCRIPTION	PATTERN	MODEL	YEAR	OEM	PCS	M3	N.W.	GW	PART LINK
4	TYG345 SB	GRILL ALL CP COMPLETE SETS WITH ALL BRACKET		TUNDRA	'12-'13	53100-0C250					

TOYOTA WISH 2008



1 GRILLE

2 FRONT BUMPER

3 REAR BUMPER



NO	CODE	DESCRIPTION	PATTERN	MODEL	YEAR	OEM	PCS	M3	N.W.	GW	PART LINK
1	53111-68010	GRILLE		WISH	'08	53111-68010					
2	52119-68903	FRONT BUMPER		WISH	'08	52119-68903 (TH)					
3	52159-68902	REAR BUMPER		WISH	'08	52159-68902 (TH)					

4 HEAD LAMP

5 TAIL LAMP

6 HOOD



NO	CODE	DESCRIPTION	PATTERN	MODEL	YEAR	OEM	PCS	M3	N.W.	GW	PART LINK
4	81110-68010	HEAD LAMP ASS'Y LH		WISH	'08	81110-68010					
	81150-68010	HEAD LAMP ASS'Y RH		WISH	'08	81150-68010					
5	81560-68040	TAIL LAMP LH		WISH	'08	81560-68040					
	81550-68040	TAIL LAMP RH		WISH	'08	81550-68040					
6	53301-68012	HOOD		WISH	'08	53301-68012					

7 FENDER

8 FRONT WIND SCREEN GLASS

9 CORNER GLASS BODY



NO	CODE	DESCRIPTION	PATTERN	MODEL	YEAR	OEM	PCS	M3	N.W.	GW	PART LINK
7	53801-68020-1	FENDER RH		WISH	'08	53801-68020-1					
	53802-68020-1	FENDER LH		WISH	'08	53802-68020-1					
8	56101-0M010	FRONT WIND SCREEN GLASS		WISH	'08	56101-0M010					
9	62710-68040	CORNER GLASS BODY RH		WISH	'08	62710-68040					
	62720-68040	COENER GLASS BODY LH		WISH	'08	62720-68040					

10 REAR WIND SCREEN GLASS



NO	CODE	DESCRIPTION	PATTERN	MODEL	YEAR	OEM	PCS	M3	N.W.	GW	PART LINK
10	68105-68051	REAR WIND SCREEN GLASS		WISH	'08	68105-68051					