

TOYOTA AVANZA '2004 / DAIHATSU XENIA '2004



1 FRONT BUMPER

2 GRILLE CHROME

3 GRILLE BLACK



NO	CODE	DESCRIPTION	PATTERN	MODEL	YEAR	OEM	PCS	M3	N.W.	GW	PART LINK
1	TYB090 NA	FRONT BUMPER	NA	TOYOTA AVANZA	'04-'05	52119-BZ040	1	0.0600	4.50	5.00	
2	53111-BZ200	GRILLE CHROME		TOYOTA AVANZA	'06	53111-BZ200					
3	53112-BZ070	GRILLE BLACK		TOYOTA AVANZA	'06	53112-BZ070					

4 HEAD LAMP

5 TAIL LAMP

6 DOOR MIRROR COVER



NO	CODE	DESCRIPTION	PATTERN	MODEL	YEAR	OEM	PCS	M3	N.W.	GW	PART LINK
4	81130-BZ030	HEAD LAMP RH UNIT		TOYOTA AVANZA	'06	81130-BZ030					
	81170-BZ030	HEAD LAMP LH UNIT		TOYOTA AVANZA	'06	81170-BZ030					
5	81550-BZ070	TAIL LAMP RH		TOYOTA AVANZA	'06	81550-BZ070					
	81560-BZ070	TAIL LAMP LH		TOYOTA AVANZA	'06	81560-BZ070					
6	87915-BZ070	DOOR MIRROR COVER RH		AVANZA	'06	87915-BZ070					
	87945-BZ070	DOOR MIRROR COVER LH		AVANZA	'06	87945-BZ070					

7 FENDER

8 REAR DOOR

9 FRONT DOOR



NO	CODE	DESCRIPTION	PATTERN	MODEL	YEAR	OEM	PCS	M3	N.W.	GW	PART LINK
7	TYF090 RA	FENDER RH		TOYOTA AVANZA	'04-'05	53811-BZ010					
	TYF090 LA	FENDER LH		TOYOTA AVANZA	'04-'05	53812-BZ010					
8	67003-BZ110	REAR DOOR RH		AVANZA	'06	67003-BZ110					
	67004-BZ110	REAR DOOR LH		AVANZA	'06	67004-BZ110					
9	67001-BZ110	FRONT DOOR RH		TOYOTA AVANZA	'06	67001-BZ110					
	67002-BZ110	FRONT DOOR LH		TOYOTA AVANZA	'06	67002-BZ110					

10 HOOD

11 ROOF PANEL

12 TRUNK LID



***NEW!!**

NO	CODE	DESCRIPTION	PATTERN	MODEL	YEAR	OEM	PCS	M3	N.W.	GW	PART LINK
10	TYH090 NA	HOOD E.D.P.		TOYOTA AVANZA	'04-'05	53301-BZ010					
11	63111-BZ010	ROOF PANEL		TOYOTA AVANZA	'06	63111-BZ010					
12	67005-BZ060	TRUNK LID		AVANZA	'06	67005-BZ060					

TOYOTA AVANZA '2004 / DAIHATSU XENIA '2004

1 LICENSE PLATE



2 LICENSE PLATE AVANZA



3 LICENSE PLATE XENIA



NO	CODE	DESCRIPTION	PATTERN	MODEL	YEAR	OEM	PCS	M3	N.W.	GW	PART LINK
1	TYLP090 NA	LICENSE PLATE	CP/SV	TOYOTA AVANZA	'04-'05		5	0.0700	5.00	6.00	
2	TYLP090 NB	LICENSE PLATE	CP/SV	TOYOTA AVANZA	'04-'05		5	0.0700	5.00	6.00	
3	TYLP090 NC	LICENSE PLATE	CP/SV	DAIHATSU XENIA	'04-'05		5	0.0700	5.00	6.00	

4 LICENSE PLATE ALL CP



5 SPOILER BACK AVANZA / XENIA



6 HOOD MOULDING



NO	CODE	DESCRIPTION	PATTERN	MODEL	YEAR	OEM	PCS	M3	N.W.	GW	PART LINK
4	TYLP090 ND	LICENSE PLATE ALL CP AVANZA	AVANZA		'04-'05	TYLP090 ND	5	0.0506	5.00	6.00	
5	TYBP090 ND	SPOILER BACK	MAT	AVANZA / XENIA	'04-'05	76085-B010	1	0.0200	1.70	1.80	
6	TYHM090 NA	HOOD MOULDING CP		TOYOTA AVANZA	'04-'05	75170-BZ010					
	75770-BZ060	HOOD MOULDING		TOYOTA AVANZA	'06	75770-BZ060					
	75770-BZ060	HOOD MOULDING		TOYOTA AVANZA	'06	75770-BZ060					

7 GRILLE RADIATOR RH



8 ENGINE COVER



9 FENDER LINER



NO	CODE	DESCRIPTION	PATTERN	MODEL	YEAR	OEM	PCS	M3	N.W.	GW	PART LINK
7	53112-BZ010	GRILLE RADIATOR RH		AVANZA	'06	53112-BZ010					
8	51441-BZ020	ENGINE COVER		TOYOTA AVANZA	'06	51441-BZ020					
9	53876-BZ010	FENDER LINER RH		TOYOTA AVANZA	'06	53876-BZ010					
	53875-BZ010	FENDER LINER LH		TOYOTA AVANZA	'06	53875-BZ010					
	65637-BZ010	FENDER LINER RH		TOYOTA AVANZA	'06	65637-BZ010					

10 RADIATOR SUPPORT



11 CROSS MEMBER



12 AIR CLEANER CASE ****NEW***



NO	CODE	DESCRIPTION	PATTERN	MODEL	YEAR	OEM	PCS	M3	N.W.	GW	PART LINK
10	53201-BZ100	RADIATOR SUPPORT		AVANZA	'06	53201-BZ100					
11	51210-BZ902	CROSS MEMBER		AVANZA	'06	51210-BZ902					
12	17700-BZ070	AIR CLEANER CASE		AVANZA	05	17700-BZ070					

13 F. SUSPENSION ARM



14 FAN GUARD 1.5CC **NEW!!**



15 WIPER GRILE



NO	CODE	DESCRIPTION	PATTERN	MODEL	YEAR	OEM	PCS	M3	N.W.	GW	PART LINK
13	48068-BZ010	F. SUSPENSION ARM RH		TOYOTA AVANZA	'04	48068-BZ010					
	48069-BZ010	F. SUSPENSION ARM LH		TOYOTA AVANZA	'04	48069-BZ010					
14	16701-BZ050	FAN GUARD 1.5CC		AVANZA	06	16701-BZ050	1	0.0271	0.96	0.96	
15	55783-bz020	WIPER GRILE RH		AVANZA	06-08	55783-BZ020	1	0.0230	0.34	0.34	

TOYOTA AVANZA '2008

1 FRONT BUMPER

****NEW****

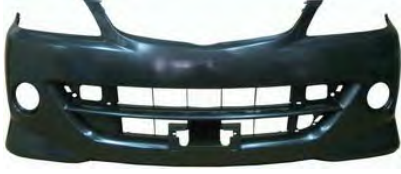

NO	CODE	DESCRIPTION	PATTERN	MODEL	YEAR	OEM	PCS	M3	N.W.	GW	PART LINK
1	52119-BZ350	FRONT BUMPER		AVANZA	08	52119-BZ350	1	0.0600	3.78	4.59	

TOYOTA AVANZA 2011-2012



1 FRONT BUMPER (INDONESIA)

2 REAR BUMPER (INDONESIA)

3



NO	CODE	DESCRIPTION	PATTERN	MODEL	YEAR	OEM	PCS	M3	N.W.	GW	PART LINK
1	TYB283 NA	FRONT BUMPER (INDONESIA)		AVANZA	'11-'12	52119-BZB00/BZA00/10/30					
2	TYB284 NA	REAR BUMPER (INDONESIA)		AVANZA	'11-'12	52159-BZ140/BZ700					

4 HEAD LAMP ASSY

5 TAIL GATE



NO	CODE	DESCRIPTION	PATTERN	MODEL	YEAR	OEM	PCS	M3	N.W.	GW	PART LINK
4	81110-BZ180	HEAD LAMP ASSY RH		AVANZA	'12	81110-BZ180					
	81150-BZ180	HEAD LAMP ASSY LH		AVANZA	'12	81150-BZ180					
5	67005-BZ540	TAIL GATE		AVANZA	'11	67005-BZ540					

TOYOTA FORTUNER 2005-'2008



1 FRONT BUMPER W/O FOG LAMP HOLE



2 FRONT BUMPER W/ FOG LAMP HOLE



3 FRONT BUMPER W/O FOG LAMP HOLE



NO	CODE	DESCRIPTION	PATTERN	MODEL	YEAR	OEM	PCS	M3	N.W.	GW	PART LINK
1	TYB173 NA	FRONT BUMPER W/O FOG LAMP HOLE		FORTUNER	'05-'09	52119-0K901					
2	TYB173 NB	FRONT BUMPER W/ FOG LAMP HOLE		FORTUNER	'05-'09	52119-0K902					
3	52119-0K949	FRONT BUMPER W/O FOG LAMP HOLE		FORTUNER	'05-'09	52119-0K901					

4 REAR BUMPER W/O SENSOR HOLE



5 REAR BUMPER W/ SENSOR HOLE



6 GRILLE BASE BK



NO	CODE	DESCRIPTION	PATTERN	MODEL	YEAR	OEM	PCS	M3	N.W.	GW	PART LINK
4	TYB174 NA	REAR BUMPER W/O SENSOR HOLE		FORTUNER	'05-'11	52159-0K901					
5	TYB174 NB	REAR BUMPER W/ SENSOR HOLE		FORTUNER	'05-'11	52159-0K902					
6	TYG093 NF	GRILLE BASE BK		FORTUNER	'05-'05	53111-0K901					

7 GRILLE VERTICAL CP/GYM



8 HOOD MOULDING ALL CP



9 HEAD LAMP CP/GY RIM



NO	CODE	DESCRIPTION	PATTERN	MODEL	YEAR	OEM	PCS	M3	N.W.	GW	PART LINK
7	TYG093 NV	GRILLE VERTICAL CP/GYM		FORTUNER	'04-'07						
8	TYHM093 NA	HOOD MOULDING ALL CP		FORTUNER	'05-'08	53121-0K030					
9	TYHL093 LA	HEAD LAMP LH CP/GY RIM		FORTUNER	'05-'06	81105-0K110/100/20-B321-05-6B					
	TYHL093 RA	HEAD LAMP RH CP/GY RIM		FORTUNER	'05-'06	81105-0K110					

10 HEAD LAMP ALL CP



11 HEAD LAMP CP/BK UNIT W/ CORNER LAMP



12 HEAD LAMP ALL CP ASSY



NO	CODE	DESCRIPTION	PATTERN	MODEL	YEAR	OEM	PCS	M3	N.W.	GW	PART LINK
10	TYHL093 LC	HEAD LAMP LH ALL CP		FORTUNER	'05-'07	81170-YZB04					
	TYHL093 RC	HEAD LAMP RH ALL CP		FORTUNER	'05-'07	81130-YZB04					
11	81106-0K100	HEAD LAMP CP/BK UNIT W/ CORNER LAMP		FORTUNER	'05	81106-0K100					
	81105-0K100	HEAD LAMP CP/BK UNIT W/ CORNER LAMP		FORTUNER	'05	81105-0K100					
12	81150-YZB04-4	HEAD LAMP ALL CP ASSY LH	OEM	FORTUNER	'05-'08	81150-YZB04-4					
	81110-YZB04-4	HEAD LAMP ALL CP ASSY RH	OEM	FORTUNER	'05-'08	81110-YZB04-4					

TOYOTA FORTUNER 2005-'2008

1 HEAD LAMP ASSY



2 FOG LAMP



3 FOG LAMP LED TYPE



NO	CODE	DESCRIPTION	PATTERN	MODEL	YEAR	OEM	PCS	M3	N.W.	GW	PART LINK
1	81150-0K100	HEAD LAMP LH ASSY	OEM	FORTUNER	'05-'06	81150-0K100					
	81110-0K100	HEAD LAMP RH ASSY	OEM	FORTUNER	'05-'06	81110-0K100					
2	TYFL091 LB	FOG LAMP LH		FORTUNER	'06						
	TYFL091 RB	FOG LAMP RH		FORTUNER	'06	81220-0K050					
3	TYFL091 LC	FOG LAMP LH LED TYPE		FORTUNER	'06						
	TYFL091 RC	FOG LAMP RH LED TYPE		FORTUNER	'06						

4 FOG LAMP UNIT



5 TAIL LAMP



6 REFLECTOR TAIL LAMP



NO	CODE	DESCRIPTION	PATTERN	MODEL	YEAR	OEM	PCS	M3	N.W.	GW	PART LINK
4	TYFL173 LA	FOG LAMP UNIT LH		FORTUNER	'05	81221-0K050					
	TYFL173 RA	FOG LAMP UNIT RH		FORTUNER	'05	81211-0K050					
5	TYL093 LA	TAIL LAMP LH		FORTUNER	'05-'08	81561-0K070					
	TYL093 RA	TAIL LAMP RH		FORTUNER	'05-'08	81551-0K070					
6	TYRL093 LA	REFLECTOR TAIL LAMP LH		FORTUNER	'05-'08	81591-0K010					
	TYRL093 RA	REFLECTOR TAIL LAMP RH		FORTUNER	'05-'08	81581-0K010					

7 TAIL LAMP COVER MAT

8 TAILLAMP COVER CHROME



9 TAIL LAMP COVER COLOR

NO	CODE	DESCRIPTION	PATTERN	MODEL	YEAR	OEM	PCS	M3	N.W.	GW	PART LINK
7	TYTC093 SA	TAIL LAMP COVER MAT		FORTUNER	'05-'07						
8	TYTC093 SB	TAILLAMP COVER CHROME		FORTUNER	'05-'07						
9	TYTC093 SC	TAIL LAMP COVER COLOR		FORTUNER	'05-'07						

10 DOOR MIRROR COVER WITH LED MAT



11 DOOR MIRROR COVER WITH LED CHROME



12 DOOR MIRROR COVER WITH LED COLOR

NO	CODE	DESCRIPTION	PATTERN	MODEL	YEAR	OEM	PCS	M3	N.W.	GW	PART LINK
10	TYMC091B LA	DOOR MIRROR COVER WITH LED MAT LH		FORTUNER	'04-'08						
	TYMC091B RA	DOOR MIRROR COVER WITH LED MAT RH		FORTUNER	'04-'08						
11	TYMC091B LB	DOOR MIRROR COVER WITH LED CHROME LH		FORTUNER	'04-'08						
	TYMC091B RB	DOOR MIRROR COVER WITH LED CHROME RH		FORTUNER	'04-'08						
12	TYMC091B LC	DOOR MIRROR COVER WITH LED COLOR LH		FORTUNER	'04-'08						
	TYMC091B RC	DOOR MIRROR COVER WITH LED COLOR RH		FORTUNER	'04-'08						

13 FENDER 4 WD



14 REAR DOOR



15 HOOD W/O TURBO HOLE



NO	CODE	DESCRIPTION	PATTERN	MODEL	YEAR	OEM	PCS	M3	N.W.	GW	PART LINK
13	53812-0K020	FENDER 4WD LH	OEM	VIGO/FORTUNER	'04-'05	53812-0K020					
	53811-0K020	FENDER 4 WD RH	OEM	VIGO/FORTUNER	'04-'05	53811-0K020					
14	67004-0K020	R. DOOR LH	OEM	FORTUNER	'05	67004-0K020					
	67003-0K020	R. DOOR RH	OEM	FORTUNER	'05	67003-0K020					
15	53301-0K010	HOOD W/O TURBO HOLE	OEM	VIGO/FORTUNER	'04-'05	53301-0K010					

TOYOTA FORTUNER 2005-'2008

1 REAR GATE



2 REAR GATE GLASS



3 ROOF PANEL



NO	CODE	DESCRIPTION	PATTERN	MODEL	YEAR	OEM	PCS	M3	N.W.	GW	PART LINK
1	67005-0K020	REAR GATE	OEM	FORTUNER	'04-'05	67005-0K020					
2	68105-0K020	REAR GATE GLASS	OEM	FORTUNER	'04-'05	68105-0K020					
3	63111-0K060	ROOF PANEL	OEM	FORTUNER	'05	63111-0K060					

4 ROOF



5 INNER FENDER FRONT



6 REAR DOOR FENDER FLARE



NO	CODE	DESCRIPTION	PATTERN	MODEL	YEAR	OEM	PCS	M3	N.W.	GW	PART LINK
4	63111-0K070	ROOF	OEM	FORTUNER	'06	63111-0K070					
5	53876-0K020	INNER FENDER FRONT LH	OEM	FORTUNER	'05	53876-0K020					
	53875-0K020	INNER FENDER FRONT RH	OEM	FORTUNER	'05	53875-0K020					
6	75742-0K901	REAR DOOR FENDER FLARE LH	OEM	FORTUNER	'05-'07	75742-0K901					
	75741-0K901	REAR DOOR FENDER FLARE RH	OEM	FORTUNER	'05	75741-0K901					

7 REAR PANEL FLARE



8 PANEL FLARE



9 SPOILER



NO	CODE	DESCRIPTION	PATTERN	MODEL	YEAR	OEM	PCS	M3	N.W.	GW	PART LINK
7	61682-0K905	REAR PANEL FLARE LH	OEM	FORTUNER	'05-'07	61682-0K905					
	61681-0K903	REAR PANEL FLARE RH	OEM	FORTUNER	'05-'07	61681-0K903					
8	52113-0K030	PANEL FLARE LH	OEM	FORTUNER	'05	52113-0K030					
	52112-0K030/31	PANEL FLARE RH	OEM	FORTUNER	'05	52112-0K030					
9	TYBP093 NA	SPOILER		FORTUNER	'05						

10 SIDE STEP BK ANODIZE 1.84 M SETS



11 SIDE STEP



12 FRONT BUMPER GUARD



NO	CODE	DESCRIPTION	PATTERN	MODEL	YEAR	OEM	PCS	M3	N.W.	GW	PART LINK
10	ST173 TY	SIDE STEP BK ANODIZE 1.84 M SETS		FORTUNER	'05-'08	53803-0K040					
11	51084-0K040	SIDE STEP LH		FORTUNER	'05	51084-0K040					
	51083-0K040	SIDE STEP RH		FORTUNER	'05	51083-0K040					
12	FG-048 TY	FRONT BUMPER GUARD		VIGO / FORTUNER	'05-'06	FG-048 TY					

13 MUDGUARD REAR



14 CONDENSOR



NO	CODE	DESCRIPTION	PATTERN	MODEL	YEAR	OEM	PCS	M3	N.W.	GW	PART LINK
13	76626-0K050	MUDGUARD REAR LH	O.E.M	FORTUNER	05-08	76626-0K050					
	76625-0K050	MUDGUARD REAR RH	O.E.M	FORTUNER	05-08	76625-0K050					
14	88460-0K030	CONDENSOR	O.E.M	FORTUNER	'04-'05	88460-0K030					

TOYOTA FORTUNER 2008-2010



1 FRONT BUMPER W/O FOG LAMP HOLE



2 FRONT BUMPER W/ FOG LAMP HOLE



3 REAR BUMPER W/O SENSOR HOLE



NO	CODE	DESCRIPTION	PATTERN	MODEL	YEAR	OEM	PCS	M3	N.W.	GW	PART LINK
1	TYB173 NA	FRONT BUMPER W/O FOG LAMP HOLE		FORTUNER	'05-'09	52119-0K901					
2	TYB173 NB	FRONT BUMPER W/ FOG LAMP HOLE		FORTUNER	'05-'09	52119-0K902					
3	TYB174 NA	REAR BUMPER W/O SENSOR HOLE		FORTUNER	'05-'11	52159-0K901					

4 REAR BUMPER W/ SENSOR HOLE



5 GRILLE GYM



6 GRILLE CP-GYM (PERFORMANCE)



NO	CODE	DESCRIPTION	PATTERN	MODEL	YEAR	OEM	PCS	M3	N.W.	GW	PART LINK
4	TYB174 NB	REAR BUMPER W/ SENSOR HOLE		FORTUNER	'05-'11	52159-0K902					
5	TYG173 NA	GRILLE GYM		FORTUNER NEW	'08-'09	53111-0K290					
6	TYG173 NB	GRILLE CP-GYM (PERFORMANCE)		FORTUNER	'08-'10	53111-0K290					

7 HOOD MOULDING ALL CP



8 HEAD LAMP UNIT RHD



9 HEAD LAMP LHD NORMAL



NO	CODE	DESCRIPTION	PATTERN	MODEL	YEAR	OEM	PCS	M3	N.W.	GW	PART LINK
7	TYHM173 NA	HOOD MOULDING ALL CP		FORTUNER NEW	'08-'09	53121-0K130					
8	TYHL173 LA	HEAD LAMP UNIT RHD LH		FORTUNER	'08-'10	81170-0K270					
	TYHL173 RA	HEAD LAMP UNIT RHD RH		FORTUNER	'08-'10	81130-0K270					
9	TYHL173 LB	HEAD LAMP LHD LH NORMAL		FORTUNER	'08-'11	81170-0K280					
	TYHL173 RB	HEAD LAMP LHD RH NORMAL		FORTUNER	'08-'11	81130-0K280					

10 HEAD LAMP RHD ELECTRIC

11 HEAD LAMP LHD ELECTRIC

12 TAIL LAMP



NO	CODE	DESCRIPTION	PATTERN	MODEL	YEAR	OEM	PCS	M3	N.W.	GW	PART LINK
10	TYHL173 LC	HEAD LAMP RHD LH ELECTRIC		FORTUNER	'08-'11	81170-0K270					
	TYHL173 RC	HEAD LAMP RHD RH ELECTRIC		FORTUNER	'08-'11	81130-0K270					
11	TYHL173 LD	HEAD LAMP LHD LH ELECTRIC		FORTUNER	'08-'11	81170-0K290					
	TYHL173 RD	HEAD LAMP LHD RH ELECTRIC		FORTUNER	'08-'11	81130-0K290					
12	TYL173 LA	TAIL LAMP LH		FORTUNER	'08-'10	81561-0K110					
	TYL173 RA	TAIL LAMP RH		FORTUNER	'08-'10	81551-0K110					

TOYOTA FORTUNER 2008-2010

1 TAIL LAMP LED

2 REFLECTOR TAIL LAMP

3 REAR REFLECTOR TAIL LAMP



NO	CODE	DESCRIPTION	PATTERN	MODEL	YEAR	OEM	PCS	M3	N.W.	GW	PART LINK
1	81590-0K020	TAIL LAMP LED LH		FORTUNER NEW	'08-'09	81590-0K020					
	81580-0K020	TAIL LAMP LED RH		FORTUNER NEW	'08-'09	81580-0K020					
2	TYRL173 LA	REFLECTOR TAIL LAMP LH		FORTUNER	'08-'10	81591-0K020					
	TYRL173 RA	REFLECTOR TAIL LAMP RH		FORTUNER	'08-'10	81581-0K020					
3	81560-0K110	REAR REFLECTOR TAIL LAMP LH		FORTUNER NEW	'08-'09	81560-0K110					
	81550-0K110	REAR REFLECTOR TAIL LAMP RH		FORTUNER NEW	'08-'09	81550-0K110					

TOYOTA FORTUNER 2011



1 GRILLE CP/GYM

2 GRILLE CP/GYM PRADO STYLE

3 GRILLE CP



NO	CODE	DESCRIPTION	PATTERN	MODEL	YEAR	OEM	PCS	NW	GW	M3	PART LINK
1	TYG177 NA	GRILLE CP/GYM		FORTUNER	'11-'12	53111-0K380	1	1.50	2.00	0.0800	
2	TYG178 NA	GRILLE CP/GYM PRADO STYLE		FORTUNER	'11-'12		1	1.50	2.00	0.0822	
3	TYG178 NC	GRILLE CP PRADO STYLE		FORTUNER	'11-'12						

4 FRONT BUMPER W/O HOLE

5 FRONT BUMPER W/ WIPER HOLE

6 FRONT BUMPER W/ WASHER HOLE



NO	CODE	DESCRIPTION	PATTERN	MODEL	YEAR	OEM	PCS	NW	GW	M3	PART LINK
4	TYB177 NA	FRONT BUMPER W/O HOLE		FORTUNER	'11-'12	52119-0K989	1	4.50	5.00	0.0600	
5	TYB177 NB	FRONT BUMPER W/ WIPER HOLE		FORTUNER	'11-'12	52119-0K989	1	4.50	5.00	0.0600	
6	52119-0K989	FRONT BUMPER W/ WASHER HOLE	OEM	FORTUNER	'11-'12	52119-0K989	1	3.70	4.60	0.0600	

7 BUMPER FINISHER

8 REAR BUMPER

9 HEAD LAMP RHD PROJECTOR MANUAL

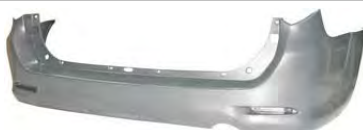

NO	CODE	DESCRIPTION	PATTERN	MODEL	YEAR	OEM	PCS	NW	GW	M3	PART LINK
7	TYBF177 NA	BUMPER FINISHER		NEW FORTUNER	'11-'12	53112-0K080	1	0.74	0.76	0.0154	
8	TYB178 NA	REAR BUMPER		FORTUNER	'11-'13	52159-0K929	1	4.00	4.50	0.0600	
9	TYHL177 LA	HEAD LAMP RHD PROJECTOR ELECTRIC LH		FORTUNER	'12-'13	81170-0K490	4	6.00	8.00	0.1200	
	TYHL177 RA	HEAD LAMP RHD PROJECTOR ELECTRIC RH		FORTUNER	'12-'13	81130-0K490	4	6.00	8.00	0.1200	

10 HEAD LAMP LHD ELECTRIC W/FAKE MORTOR

11 HEAD LAMP RHD PROJECTOR ELECTRIC

12 HEAD LAMP LHD ELECTRIC W/REAL MORTOR



NO	CODE	DESCRIPTION	PATTERN	MODEL	YEAR	OEM	PCS	NW	GW	M3	PART LINK
10	TYHL177 LB	HEAD LAMP LHD ELECTRIC W/FAKE MORTOR LH		FORTUNER	'12-'13		0	0.00	0.00	0.0000	
	TYHL177 RB	HEAD LAMP LHD ELECTRIC W/FAKE MORTOR RH		FORTUNER	'12-'13		0	0.00	0.00	0.0000	
11	TYHL177 LC	HEAD LAMP RHD PROJECTOR ELECTRIC LH		FORTUNER	'12-'13	81170-0K490	0	0.00	0.00	0.0000	
	TYHL177 RC	HEAD LAMP RHD PROJECTOR ELECTRIC RH		FORTUNER	'12-'13	81130-0K490	0	0.00	0.00	0.0000	
12	TYHL177 LD	HEAD LAMP LHD ELECTRIC W/REAL MORTOR LH		FORTUNER	'12-'13		0	0.00	0.00	0.0000	
	TYHL177 RD	HEAD LAMP LHD ELECTRIC W/REAL MORTOR RH		FORTUNER	'12-'13		0	0.00	0.00	0.0000	

13 FOG LAMP COVER

14 FOG LAMP ASSY

15 FOG LAMP SUPPORT



NO	CODE	DESCRIPTION	PATTERN	MODEL	YEAR	OEM	PCS	NW	GW	M3	PART LINK
13	TYFC177 LA	FOG LAMP COVER LH		FORTUNER	'11-'13	52128-0K040	5	2.00	2.00	0.0300	
	TYFC177 RA	FOG LAMP COVER RH		FORTUNER	'11-'13	52127-0K040	5	2.00	2.00	0.0300	
14	81220-0K080	FOG LAMP ASSY LH	OEM	VIGO SMART CAP / FORTUNER	'08-'12	81220-0K080	1	0.19	0.33	0.0054	
	81210-0K080	FOG LAMP ASSY RH	OEM	VIGO SMART CAP / FORTUNER	'08-'12	81210-0K080	1	0.19	0.32	0.0056	
15	81482-0K040	FOG LAMP SUPPORT LH	OEM	VIGO CHAMP/FORTUNER	'11-'12	81482-0K040	1	1.00	1.00	0.0100	
	81481-0K050	FOG LAMP SUPPORT RH	OEM	VIGO CHAMP/FORTUNER	'11-'12	81481-0K050	1	1.00	1.00	0.0100	

TOYOTA FORTUNER 2011

1 FOG LAMP WITH WIRE SET



2 TAIL LAMP



3 TAIL LAMP

OEM



NO	CODE	DESCRIPTION	PATTERN	MODEL	YEAR	OEM	PCS	NW	GW	M3	PART LINK
1	TYFL175 LA	FOG LAMP LH WITH WIRE SET		VIGO / FORTUNER	'12	81220-0K080	0	0.00	0.00	0.0000	
	TYFL175 RA	FOG LAMP RH WITH WIRE SET		VIGO / FORTUNER	'12	81210-0K080	0	0.00	0.00	0.0000	
2	TYL177 LA	TAIL LAMP LH		FORTUNER	'12-'13	81560-0K200	0	0.00	0.00	0.0000	
	TYL177 RA	TAIL LAMP RH		FORTUNER	'12-'13	81550-0K190	0	0.00	0.00	0.0000	
3	81560-0K200	TAIL LAMP LH	OEM	FORTUNER	'11	81560-0K200	0	0.00	0.00	0.0000	
	81550-0K190	TAIL LAMP RH	OEM	FORTUNER	'11	81550-0K190	0	0.00	0.00	0.0000	

4 TAIL LAMP REFLECTOR



5 TAIL LAMP REFLECTOR

OEM



6 BUMPER REFLECTOR

NO	CODE	DESCRIPTION	PATTERN	MODEL	YEAR	OEM	PCS	NW	GW	M3	PART LINK
4	TYRL177 LA	TAIL LAMP REFLECTOR LH	REM	FORTUNER	'12-'13	81590-0K030	0	0.00	0.00	0.0000	
	TYRL177 RA	TAIL LAMP REFLECTOR RH	REM	FORTUNER	'12-'13	81580-0K030	0	0.00	0.00	0.0000	
5	81590-0K030	TAIL LAMP REFLECTOR LH	OEM	FORTUNER	'11	81590-0K030	0	0.00	0.00	0.0000	
	81580-0K030	TAIL LAMP REFLECTOR RH	OEM	FORTUNER	'11	81580-0K030	0	0.00	0.00	0.0000	
6	81920-0K010	BUMPER REFLECTOR LH		FORTUNER	'11	81920-0K010	0	0.00	0.00	0.0000	
	81910-0K030	BUMPER REFLECTOR RH		FORTUNER	'11	81910-0K030	0	0.00	0.00	0.0000	

7 BUMPER SUPPORT F-R/L



NO	CODE	DESCRIPTION	PATTERN	MODEL	YEAR	OEM	PCS	NW	GW	M3	PART LINK
7	52116-0K080	BUMPER SUPPORT F-LH		FORTUNER	'11	52116-0K080					
	52115-0K080	BUMPER SUPPORT F-RH		FORTUNER	'11	52115-0K080					

TOYOTA HIACE VAN '1983-'1985



1 GRILLE HIACE '83-'85

2 H/L DOOR HIACE '83-'85

3 GRILLE HIACE '85-'89



NO	CODE	DESCRIPTION	PATTERN	MODEL	YEAR	OEM	PCS	M3	N.W.	GW	PART LINK
1	TYG020 NA	GRILLE GY '83-'85	GY	HIACE YH 20	'83-'85	53111-29205	5	0.0828	7.50	9.50	
2	TYD020 LA	H/L DOOR BK '83-'85	BK	HIACE	'83-'85	53140-29155	5	0.0331	2.00	3.00	
	TYD020 RA	H/L DOOR BK '83-'85	BK	HIACE	'83-'85	53130-29155	5	0.0331	2.00	3.00	
3	TYG045 NA	GRILLE BK '85-'89	BK	HIACE LH60	'85-'89	53111-95J09	5	0.0966	6.00	8.50	
	TYG045 NB	GRILLE BK/SV '85-'89	BK/SV	HIACE LH60	'85-'89	53111-95J10	5	0.0966	6.00	8.50	

4 H/L DOOR HIACE '85-'89

5 CORNER LAMP '83-'86

6 TAIL LAMP '84-'86

7-8 SIDE BUMPER '89-'95

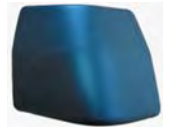
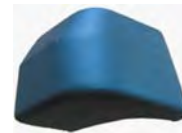

F

R

NO	CODE	DESCRIPTION	PATTERN	MODEL	YEAR	OEM	PCS	M3	N.W.	GW	PART LINK
4	TYD045 LA	H/L DOOR BK '85-'89	BK	HIACE	'85-'89	53140-95J05	5	0.0331	2.00	3.00	
	TYD045 RA	H/L DOOR BK '85-'89	BK	HIACE	'85-'89	53130-95J05	5	0.0331	2.00	3.00	
	TYD045 LB	H/L DOOR BK/SV '85-'89	SV/BK	HIACE	'85-'89	53140-95J06	5	0.0331	2.00	3.00	
	TYD045 RB	H/L DOOR BK/SV '85-'89	SV/BK	HIACE	'85-'89	53130-95J06	5	0.0331	2.00	3.00	
5	TYCL020 RA	CORNER LAMP RH		HIACE	'83-'85	81510-29835					
	TYCL020 LA	CORNER LAMP LH		HIACE	'83-'85	81520-29835					
6	TYL020 RA	TAIL LAMP RH		HIACE LH61	'84-'86	81550-80153					
	TYL020 LA	TAIL LAMP LH		HIACE LH61	'84-'86	81560-80158					
7	52112-29035	F.SIDE BUMPER RH		HIACE	'89-'95	52112-29035					
	52113-29035	F.SIDE BUMPER LH		HIACE	'89-'95	52113-29035					
8	52165-29015	R.SIDE BUMPER RH		HIACE	'89-'95	52165-29015					
	52166-29015	R.SIDE BUMPER LH		HIACE	'89-'95	52166-29015					

TOYOTA HIACE VAN '1990-'1992 U-LH113K



1 GRILLE '90-'92



NO	CODE	DESCRIPTION	PATTERN	MODEL	YEAR	OEM	PCS	M3	N.W.	GW	PART LINK
1	TYG031 NA	GRILLE	MAT GY	HIACE U-LH113	'90-'92		1				

TOYOTA HI ACE VAN '1989-'1994 /YH113 '1995



1 GRILLE MAT/D-GY **NA**



2 GRILLE GY **NB**



3 GRILLE ALL CP **NC**

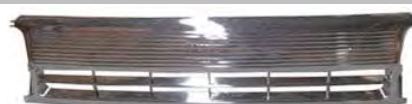

NO	CODE	DESCRIPTION	PATTERN	MODEL	YEAR	OEM	PCS	M3	N.W.	GW	PART LINK
1	TYG055 NA	GRILLE	MAT/D-GY	HIACE YH113	'94-'95	53100-26011/70	5	0.0850	2.50	3.50	
2	TYG055 NB	GRILLE	GY	HIACE YH112	'89-'94	53100-26011(70)	5	0.0850	2.50	3.50	
3	TYG055 NC	GRILLE	ALL CP	HIACE	'89-'95	PERFORMANCE	5	0.0850	6.00	7.00	

4 GRILLE HIACE YH125



5 GRILLE GYM **NA**



6 GRILLE CP/GYM **NB**



NO	CODE	DESCRIPTION	PATTERN	MODEL	YEAR	OEM	PCS	M3	N.W.	GW	PART LINK
4	TYG065 NB	GRILLE	CP	HIACE YH125	'95	BRIGHT	1	0.0682	2.00	2.00	
5	TYG068 NA	GRILLE	GYM	HIACE	'97-'98	53111-26130/140A	5	0.0410	3.50	4.00	
6	TYG068 NB	GRILLE	CP/GYM	HIACE	'97-'98	53100-26110	5	0.0410	4.00	5.00	
	TYG068 NC	GRILLE ALL CP		HIACE	'97-'98						

7 F.BUMPER HIACE YH112



8 FRONT BUMPER MAT/BK **NA**



9 FRONT BUMPER W/O MOULDING **NB**



NO	CODE	DESCRIPTION	PATTERN	MODEL	YEAR	OEM	PCS	M3	N.W.	GW	PART LINK
7	TYB063 NA	F.BUMPER	MAT/BK	HIACE YH112	'91-'93	52119-95J24	5	0.3000	19.00	24.00	
8	TYB065 NA	F.BUMPER	MAT/BK	HIACE LH125	'95	52119-26060	5	0.3000	22.00	24.00	
9	TYB065 NB	F.BUMPER W/O MOULDING		HIACE LH125	'95	52119-26060	5	0.3000	22.00	24.00	

10 F.BUMPER HIACE LH113



11 R.BUMPER YH112,YH125



12 HEAD LAMP HIACE YH125



NO	CODE	DESCRIPTION	PATTERN	MODEL	YEAR	OEM	PCS	M3	N.W.	GW	PART LINK
10	TYB068 NA	F.BUMPER	MAT/BK	HIACE LH113	'98-'99	52119-26200	5	0.3000	24.00	28.00	
11	TYB066 NA	R.BUMPER	MAT/BK	YH112,YH125	'89-'97	52159-95J26	5	0.2000	20.00	22.00	
12	TYHL065 LA	HEAD LAMP LH		HIACE YH125	'95-'96	81150-26070	4	0.0600	4.00	6.00	
	TYHL065 RA	HEAD LAMP RH		HIACE YH125	'95-'96	81110-26070	4	0.0600	4.00	6.00	

13 CORNER LAMP YH112



14 CORNER LAMP HIACE YH125



15 FOG LAMP COVER LH113



NO	CODE	DESCRIPTION	PATTERN	MODEL	YEAR	OEM	PCS	M3	N.W.	GW	PART LINK
13	TYCL055 LA	CORNER LAMP LH		YH112	'86-'96	81520-95J16	20	0.0664	6.00	7.00	
	TYCL055 RA	CORNER LAMP RH		YH112	'86-'96	81510-95J16	20	0.0664	6.00	7.00	
14	TYCL065 LA	CORNER LAMP LH		HIACE YH125	'95-'96	81620-26050-B2	20	0.1000	10.00	12.00	
	TYCL065 RA	CORNER LAMP RH		HIACE YH125	'95-'96	81610-26050-B2	20	0.1000	10.00	12.00	
15	TYFC068 LA	FOG LAMP COVER LH	BK	HIACE LH113	'98-'99	52128-26020	50	0.0300	2.00	3.00	
	TYFC068 RA	FOG LAMP COVER RH	BL	HIACE LH113	'98-'99	52127-26020	50	0.0300	2.00	3.00	

TOYOTA HI ACE VAN '1989-'1994 /YH113 '1995

1 FRONT LAMP HIACE YH125



2 TAIL LAMP YH112,YH125



3 LAMP HOUSING



NO	CODE	DESCRIPTION	PATTERN	MODEL	YEAR	OEM	PCS	M3	N.W.	GW	PART LINK
1	TYFL065 LA	FRONT LAMP LH		HIACE YH125	'95-'96	81520-26070	20	0.0500	4.00	6.00	
	TYFL065 RA	FRONT LAMP RH		HIACE YH125	'95-'96	81510-26070	20	0.0500	4.00	6.00	
2	TYL065 LA	TAIL LAMP BK LH		YH112,YH125	'89-'99	81560-95J11	10	0.1200	8.00	10.00	
	TYL065 RA	TAIL LAMP BK RH		YH112,YH125	'89-'99	81550-95J11	10	0.1200	8.00	10.00	
	TYLZ065 LA	TAIL LAMP LENS		HIACE,YH112	'89-'97	81560-95J11	50	0.0800	5.00	6.00	
	TYLZ065 RA	TAIL LAMP LENS		HIACE,YH112	'89-'97	81550-95J11	50	0.0800	5.00	6.00	
3	TYLH055 LA	LAMP HOUSING LH		HIACE	'89-'95	81150-95J40					
	TYLH055 RA	LAMP HOUSING RH		HIACE	'89-'95	81110-95J40					

4 DOOR MIRROR



LH112



LH113

5 H/L DOOR MAT/D-GY

R/LA A



6 H/L DOOR GY

R/LB A



NO	CODE	DESCRIPTION	PATTERN	MODEL	YEAR	OEM	PCS	M3	N.W.	GW	PART LINK
4	TYMR055 LA	DOOR MIRROR LH		HIACE LH112	'89-'95						
	TYMR055 RA	DOOR MIRROR RH		HIACE LH112	'89-'95						
	TYMR065 LA	DOOR MIRROR LH		HIACE LH113	'95-'96	TYMR065 LA					
	TYMR065 RA	DOOR MIRROR RH		HIACE LH113	'95-'96	TYMR065 RA					
5	TYD055 LA	H/L DOOR LH	MAT/D-GY	HIACE YH112	'89-'94	53132-95J10	5	0.0482	2.50	3.50	
	TYD055 RA	H/L DOOR RH	MAT/D-GY	HIACE YH112	'89-'94	53131-95J10	5	0.0482	2.50	3.50	
6	TYD055 RB	H/L DOOR RH	GY	HIACE	'89-'95	53131-26020	5	0.0482	2.50	3.00	
	TYD055 LB	H/L DOOR LH	GY	HIACE	'89-'95	53132-26020	5	0.0482	2.50	3.50	

7 H/L DOOR ALL CP

R/LC A



8 H/L DOOR GYM

R/LA A



9 H/L DOOR ALL CP

R/LB A



NO	CODE	DESCRIPTION	PATTERN	MODEL	YEAR	OEM	PCS	M3	N.W.	GW	PART LINK
7	TYD055 LC	H/L DOOR LH	ALL CP	HIACE	'89-'95	53132-26020	5	0.0482	2.50	3.50	
	TYD055 RC	H/L DOOR RH	ALL CP	HIACE	'89-'95	53131-26020	5	0.0000	2.50	3.50	
8	TYD068 LA	H/L DOOR LH	GYM	YH113	'98-'99	53140-26010	5	0.0482	3.00	4.00	
	TYD068 RA	H/L DOOR RH	GYM	YH113	'98-'99	53130-26010	5	0.0482	3.00	4.00	
9	TYD068 LB	H/L DOOR LH	ALL CP	YH113	'98-'99	53140-26010	5	0.0482	3.00	4.00	
	TYD068 RB	H/L DOOR RH	ALL CP	YH113	'98-'99	53130-26010	5	0.0482	3.00	4.00	

10 FRONT DOOR



11 CENTER DOOR



12-13 TAIL GATE



14 AIR FILTER



NO	CODE	DESCRIPTION	PATTERN	MODEL	YEAR	OEM	PCS	M3	N.W.	GW	PART LINK
10	TYFD055 LA	FRONT DOOR LH		HIACE	'89-'02	67002-26131/95J	1	0.1100	11.00	12.00	
	TYFD055 RA	FRONT DOOR RH		HIACE	'89-'02	67001-26131/95J	1	0.1100	11.00	12.00	
11	TYFD055 CA	CENTER DOOR		HIACE	'97-'99	67003-95J23					
12	TYT055 NA	TAIL GATE		HIACE	'89-'95	67005-95N49					
13	TYT068 NA	TAIL GATE		HIACE	'97-'99						
14	17801-54100	AIR FILTER		HIACE	'85-'89	17801-54100					

15 F.PANEL ASS'Y '89-'95



16 F.PANEL ASS'Y '97-'99



17 REINFORCEMENT HIACE



NO	CODE	DESCRIPTION	PATTERN	MODEL	YEAR	OEM	PCS	M3	N.W.	GW	PART LINK
15	TYFP055 NA	F.PANEL ASS'Y		HIACE	'89-'95	55701-95J22					
16	TYFP068 NA	F.PANEL ASS'Y		HIACE	'97-'99						
17	TYBR063 NA	BUMPER REINFORCEMENT		HIACE	'93-'96	52801-26060					
18	TYWFO65 NA	WINDOW FRAME HIACE (F/R,L/R) W/ GLASS	HIACE		'95		1	0.0600	8.00	10.00	

TOYOTA HIACE YH133V '1993-'1999



1 GRILLE HORIZONTAL NA



2 GRILLE HORIZONTAL TYPR NB



3 GRILLE HONEY TYPE NA



NO	CODE	DESCRIPTION	PATTERN	MODEL	YEAR	OEM	PCS	M3	N.W.	GW	PART LINK
1	TYG033 NA	GRILLE HORIZONTAL	GY	YH133	'93-'99	53100-26060					
2	TYG033 NB	GRILLE HORIZONTAL TYPR	CP	YH133	'93-'99	PERFORMANCE					
3	TYG035 NA	GRILLE HONEY TYPE	GY	YH133	'93-'99	53111-26210					

4 GRILLE HONEY TYPE NB



5 FRONT BUMPER



6 FRONT BUMPER (BIG)



NO	CODE	DESCRIPTION	PATTERN	MODEL	YEAR	OEM	PCS	M3	N.W.	GW	PART LINK
4	TYG035 NB	GRILLE HONEY TYPE	ALL CP	YH133	'93-'99						
5	TYB033 NA	FRONT BUMPER	BK	YH133	'93-'99	52119-95J21					
6	TYB035 NA	F. BUMPER BROADEN		HIACE YH B3	'93-'99	52119-26300					

7 HEAD LAMP



8 CORNER LAMP



9 CORNER LAMP



NO	CODE	DESCRIPTION	PATTERN	MODEL	YEAR	OEM	PCS	M3	N.W.	GW	PART LINK
7	TYHL033 RA	HEAD LAMP RH		YH133	'93-'99	81130-26060					
	TYHL033 LA	HEAD LAMP LH		YH133	'93-'99	81170-26060					
	TYHL033 RB	HEAD LAMP RH CRYSTAL		YH133	'93-'99						
	TYHL033 LB	HEAD LAMP LH CRYSTAL		YH133	'93-'99						
8	TYCL033 RA	CORNER LAMP RH GY		YH133	'93-'99	81610-26030					
	TYCL033 LA	CORNER LAMP LH GY		YH133	'93-'99	81620-26030					
	TYCL033 RB	CORNER LAMP RH CP		YH133	'93-'99						
	TYCL033 LB	CORNER LAMP LH CP		YH133	'93-'99						
9	TYCL031 RA	CORNER LAMP RH SEAL BEAM		HIACE YH133V	'93-'95	81610-95J03					
	TYCL031 LA	CORNER LAMP LH SEAL BEAM		HIACE YH133V	'93-'95	81620-95J03					

10 LENS MOULDING



11 LENS MOULDING



12 CONDENSER



NO	CODE	DESCRIPTION	PATTERN	MODEL	YEAR	OEM	PCS	M3	N.W.	GW	PART LINK
10	TYLM033 RA	LENS MOULDING RH AMBER	AMBER	YH133	'93-'99						
	TYLM033 LA	LENS MOULDING LH AMBER	AMBER	YH133	'93-'99						
11	TYLM033 RB	LENS MOULDING RH CLEAR	CLEAR	YH133	'93-'99						
	TYLM033 LB	LENS MOULDING LH CLEAR	CLEAR	YH133	'93-'99						
12	CL3054	CONDENSER		HIACE	1998-00	88460-26330					

TOYOTA HIACE YH133V '1993-'1999

1-2 DOOR SLIDE BAR S. AFRICA



3 MIRROR FRAME S. AFRICA



4 PILLAR SUB ASS'Y FRONT S. AFRICA



NO	CODE	DESCRIPTION	PATTERN	MODEL	YEAR	OEM	PCS	M3	N.W.	GW	PART LINK
1	TYDR055 LA	SLIDE DOOR RAIL LOWER (STANLESS)		HIACE S.AFRICA	'90-'04	TA0600RR01	1	0.0050	1.00	1.00	
2	TYDR055 UA	SLIDE DOOR RAIL UPPER (STEEL)		HIACE S.AFRICA	'90-'04	TA0600RR03	1	0.0050	0.50	0.50	
3	TYMF055 RA	MIRROR FRAME		HIACE S.AFRICA	'90-'04	TA0600MB02					
	TYMF055 LA	MIRROR FRAME		HIACE S.AFRICA	'90-'04	TA0600MB01					
4	TYWP055 RA	PILLAR SUB ASS'Y FRONT		HIACE S.AFRICA	'90-'04	61027-95J01	1	0.1000	20.00	22.00	
	TYWP055 LA	PILLAR SUB ASS'Y FRONT		HIACE S.AFRICA	'90-'04	61028-95J01	1	0.1000	20.00	22.00	

5 FRONT PANEL ASSY

NEW!!!!



NO	CODE	DESCRIPTION	PATTERN	MODEL	YEAR	OEM	PCS	M3	N.W.	GW	PART LINK
5	TYFP055 NA	FRONT PANEL ASSY		HIACE	94-95	55701-95J22	1	0.1500	12.00	13.00	

TOYOTA HIACE LH172 '2000-'2002



1 GRILLE MAT GY

NA

2 GRILLE CP/GYM

NB

3 FRONT BUMPER



NO	CODE	DESCRIPTION	PATTERN	MODEL	YEAR	OEM	PCS	M3	N.W.	GW	PART LINK
1	TYG088 NA	GRILLE MAT GY		HIACE LH172	'00-'02	53100-26180	5	0.1000	8.00	10.00	
2	TYG088 NB	GRILLE CP/GYM		HIACE LH172	'00-'02	53100-26190	5	0.1000	8.00	10.00	
3	TYB069 NA	F.BUMPER		HIACE LH172	'00-'02	52119-26904 (1)	5	0.3000	24.00	28.00	

4 HEAD LAMP

5 CORNER LAMP

6 CORNER LAMP (CRYSTAL)

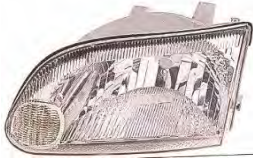

NO	CODE	DESCRIPTION	PATTERN	MODEL	YEAR	OEM	PCS	M3	N.W.	GW	PART LINK
4	TYHL088 RA	HEAD LAMP RH		HIACE LH172	'00-'02	81110-26230	4	0.1378	6.00	8.00	
	TYHL088 LA	HEAD LAMP LH		HIACE LH172	'00-'02	81150-26130	4	0.1378	6.00	8.00	
5	TYCL088 RA	CORNER LAMP RH		HIACE LH172	'00-'02	81610-26080	20	0.1467	8.00	10.00	
	TYCL088 LA	CORNER LAMP LH		HIACE LH172	'00-'02	81620-26080	20	0.1467	8.00	10.00	
6	TYCL088 RB	CORNER LAMP RH	CRYSTAL	HIACE LH172	'00-'02	81610-26070	20	0.1467	8.00	10.00	
	TYCL088 LB	CORNER LAMP LH	CRYSTAL	HIACE LH172	'00-'02	81620-26070	20	0.1467	8.00	10.00	

7 FOG LAMP

8 TAIL LAMP

9 STEP PANEL



NO	CODE	DESCRIPTION	PATTERN	MODEL	YEAR	OEM	PCS	M3	N.W.	GW	PART LINK
7	TYFL088 RA	FOG LAMP RH		HIACE LH172	'00-'02	81210-26050	6	0.0967	4.00	5.00	
	TYFL088 LA	FOG LAMP LH		HIACE LH172	'00-'02	81220-26050	6	0.0967	4.00	5.00	
8	TYL088 RA	TAIL LAMP RH		HIACE LH172	'00-'02	81550-26330	10	0.0840	8.00	10.00	
	TYL088 LA	TAIL LAMP LH		HIACE LH172	'00-'02	81560-26330	10	0.0840	8.00	10.00	
9	TYPL088 RA	STEP PANEL RH		HIACE LH172	'00-'02	51773-26010-C0					
	TYPL088 LA	STEP PANEL LH		HIACE LH172	'00-'02	51774-26010-C0					

TOYOTA HIACE COMUTER / QUANTUM '2004-'2010



1 FRONT BUMPER

FRONT BUMPER

2 F.BUMPER SHORT LOW ROOF

3 R.BUMPER SHORT LOW ROOF



NO	CODE	DESCRIPTION	PATTERN	MODEL	YEAR	OEM	PCS	M3	N.W.	GW	PART LINK
1	TYB221 NA	F.BUMPER LONG HIGH ROOF BK		COMUTER	'04-'10	52119-26931/26490					
2	TYB219 NA	F. BUMPER SHORT LOW ROOF		COMUTER	'04-'10	52119-26440					
3	TYB220 NA	R. BUMPER SHORT LOW ROOF		COMUTER	'04-'11	52159-26250					

4 REAR BUMPER LONG HIGH ROOF

5 REAR BUMPER LOHG HIGH ROOF

6 GRILLE CP/GYM NA



AFRICANS

THAILAND

HONG KONG



NO	CODE	DESCRIPTION	PATTERN	MODEL	YEAR	OEM	PCS	M3	N.W.	GW	PART LINK
4	TYB221 NC	R.BUMPER LONG HIGH ROOF		COMUTER	04						
5	TYB222 NA	R.BUMPER LONG HIGH ROOF BK		COMUTER	'04-'06	52159-26340					
6	TYG225 NA	GRILLE	CP/GYM	VENTURY	'04-'10	53100-DX010					

7 GRILLE ALL CP

NC

8 GRILLE SV/BK LONG 1200 MM NA

9 GRILLE CP/BK LONG 1200 MM NB



NO	CODE	DESCRIPTION	PATTERN	MODEL	YEAR	OEM	PCS	M3	N.W.	GW	PART LINK
7	TYG225 NC	GRILLE ALL CP	ALL CP	VENTURY	'04-'10	53100-DX010					
8	TYG221 NA	GRILLE SV/BK LONG 1200 MM		COMUTER	'04-'08	53111-26360/53100-26230					
9	TYG221 NB	GRILLE CP/BK LONG 1200 MM		COMUTER	'04-'08	53111-26370/53100-26240					

10 GRILLE SHORT LOW ROOF SV/BK

NA

11 GRILLE SHORT LOW ROOF CP/BK

NB

12 GRILLE SHORT SV / BK

NA



NO	CODE	DESCRIPTION	PATTERN	MODEL	YEAR	OEM	PCS	M3	N.W.	GW	PART LINK
10	TYG219 NA	GRILLE SHORT LOW ROOF	SV/BK	COMUTER	'04-'10	53111-26340/53100-26220					
11	TYG219 NB	GRILLE SHORT LOW ROOF	CP/BK	COMUTER	'04-'10	53111-26350/53100-26210					
12	TYG220 NA	GRILLE SHORT SV/BK		COMUTER	09-10						

13 GRILLE SHORT CP/BK

NB

14 GRILLE UPPER MOULDING

15 HEAD LAMP LONG



NO	CODE	DESCRIPTION	PATTERN	MODEL	YEAR	OEM	PCS	M3	N.W.	GW	PART LINK
13	TYG220 NB	GRILLE SHORT CP/BK		COMUTER	09-10						
14	TYGM225 NA	GRILLE MOULDING VENTUR` ALL CP		VENTURY	'04-'10	75770-DX901					
15	81130-26440	HEAD LAMP RH LONG		COMUTER	04-05	81130-26440					
	81170-26440	HEAD LAMP LH LONG		COMUTER	04-05	81170-26440					

TOYOTA HIACE COMUTER / QUANTUM '2004-'2010

1 HEAD LAMP RHD E-MARK

R/LA A

2 HEAD LAMP

R/LB A

3 RECONFIGURE PLATING CRYSTAL R/LC



NO	CODE	DESCRIPTION	PATTERN	MODEL	YEAR	OEM	PCS	M3	N.W.	GW	PART LINK
1	TYHL221 RA	HEAD LAMP RHD RH E-MARK		COMUTER	'04-'10	81110-26440					
	TYHL221 LA	HEAD LAMP LH RHD E-MARK		COMUTER	'04-'10	81150-26440					
2	TYHL221 RB	RECONFIGURE BLACK CRYSTAL HEAD LAMP RH		COMUTER	'04-'10						
	TYHL221 LB	RECONFIGURE BLACK CRYSTAL HEAD LAMP LH		COMUTER	'04-'10						
3	TYHL221 RC	RECONFIGURE PLATING CRYSTAL RH		COMUTER	'04-'10						
	TYHL221 LC	RECONFIGURE PLATING CRYSTAL LH		COMUTER	'04-'10						

4 FOG LAMP LONG

5 FOG LAMP SHORT

6 FOG LIGHT COVER CP



NO	CODE	DESCRIPTION	PATTERN	MODEL	YEAR	OEM	PCS	M3	N.W.	GW	PART LINK
4	TYFL221 RA	FOG LAMP LONG RH		COMUTER	'04-'10	81220-52051					
	TYFL221 LA	FOG LAMP LONG LH		COMUTER	'04-'10	81210-52051					
5	TYFL219 RA	FOG LAMP RH SHORT		HIACE	04-'11	81210-52050					
	TYFL219 LA	FOG LAMP LH SHORT		HIACE	04-'11	81220-52050					
6	TYFC221 SB	FOG LIGHT COVER CP		COMUTER	04-'11						

7 FOG LAMP COVER ROUND

8 FOG LAMP COVER BASE

R/LA A

9 FOG LAMP COVER LONG

R/LB A



NO	CODE	DESCRIPTION	PATTERN	MODEL	YEAR	OEM	PCS	M3	N.W.	GW	PART LINK
7	81482-26050	FOG LAMP COVER ROUND LH		HIACE	04-'10	81482-26050					
	81481-26050	FOG LAMP COVER ROUND RH		HIACE	04-'10	81481-26050					
8	TYFC221 RA	FOG LAMP COVER BASE RH		COMUTER	'04-'10	53112-26020					
	TYFC221 LA	FOG LAMP COVER BASE LH		COMUTER	'04-'10	53113-26020					
9	TYFC221 RB	FOG LAMP COVER RH LONG CP		COMUTER	'04-'10						
	TYFC221 LB	FOG LAMP COVER LH LONG CP		COMUTER	'04-'10						

10 FOG LAMP COVER RH SHORT

11 TAIL LAMP

R/LA A

12-31.8. TAIL LAMP UNIT

R/LB A



NO	CODE	DESCRIPTION	PATTERN	MODEL	YEAR	OEM	PCS	M3	N.W.	GW	PART LINK
10	TYFC219 RB	FOG LAMP COVER RH SHORT CP		COMUTER	'04-'10						
	TYFC219 LB	FOG LAMP COVER LH SHORT CP		COMUTER	'04-'10						
11	TYL221 RA	TAIL LAMP ASSY RH		COMUTER	'04-'10	81551-26200					
	TYL221 LA	TAIL LAMP ASSY LH		COMUTER	'04-'10	51561-26200					
12	TYL221 RB	TAIL LAMP UNIT RH		COMUTER	'04-'10	81551-26200					
	TYL221 LB	TAIL LAMP UNIT LH		COMUTER	'04-'10	51561-26200					

13-14 DOOR MIRROR

15 FRONT DOOR

16 DOOR LHD



NO	CODE	DESCRIPTION	PATTERN	MODEL	YEAR	OEM	PCS	M3	N.W.	GW	PART LINK
13	TYMR221 LA	DOOR MIRROR BK LH		COMUTER	04-'10	87940-26451/26400					
	TYMR221 RA	DOOR MIRROR RH BK		COMUTER	04-'10	87910-26451/26400					
14	TYMR221 RB	DOOR MIRROR (CP)		COMUTER	04-'10						
	TYMR221 LB	DOOR MIRROR (CP)		COMUTER	04-'10						
15	TYFD221 RA	FRONT DOOR RH		COMUTER	04-'11	67001-26300					
	TYFD221 LA	FRONT DOOR LH		COMUTER	04-'11	67002-26280/26291					
16	TYD221 CA	DOOR LHD		HIACE	04						

TOYOTA HIACE COMUTER / QUANTUM '2004-'2010

1 SLIDE DOOR FOR HIGH ROOF



2 SLIDE DOOR



3 PANEL, QUARTER , OUTER



****NEW****

NO	CODE	DESCRIPTION	PATTERN	MODEL	YEAR	OEM	PCS	M3	N.W.	GW	PART LINK
1	67004-26600	SLIDE DOOR FOR HIGH ROOF OEM		COMUTER	04-'11	67004-26600					
2	TYFD221 CA	SLIDE DOOR FOR LOW ROOF RHD		COMUTER	04-'11	67004-26640					
	TYFD221 CB	SLIDE DOOR FOR LOW ROOF LHD		COMUTER	04-'11						
	TYFD221 CC	SLIDE DOOR LOW ROOF CLOSE RHD		COMUTER	04-'11	67004-26640					
	TYFD221 CD	SLIDE DOOR LOW ROOF CLOSE LHD		COMUTER	04-'11						
3	61612-26560	PANEL, QUARTER , OUTER LH		HIACE	04-11	61612-26560	1	0.4646	16.00	18.00	

4 TAIL GATE HIGH ROOF



5 REAR DOOR LOW ROOF WIDE BODY 1880 MM



6 TAIL GATE LOW ROOF 1695



NO	CODE	DESCRIPTION	PATTERN	MODEL	YEAR	OEM	PCS	M3	N.W.	GW	PART LINK
4	67005-26D070	TAIL GATE HIGH ROOF 1880 W/O HOLE		COMUTER	'04-'11	67005-26D70/71					
	67005-26D61	TAIL GATE HIGH ROOF 1880 MM W/ HOLE		COMUTER	04-'11	67005-26D61/E61					
5	TYT221 NA	REAR DOOR LOW ROOF WIDE BODY W/O HOLE		COMUTER	'04-'11						
	TYT221 NB	REAR DOOR LOW ROOF WIDE BODY W/ HOLE		COMUTER	'04-'11						
6	TYT219 NA	TAIL GATE LOW ROOF 1695 MM W/O HOLE		COMUTER	'04-'11	67005-26D10					
	TYT219 NB	TAIL GATE LOW ROOF 1695 MM W/ HOLE		COMUTER	'04-'11						

7 DASH BOARD LHD



8 DASH BOARD LHD



9 DASH BOARD



NO	CODE	DESCRIPTION	PATTERN	MODEL	YEAR	OEM	PCS	M3	N.W.	GW	PART LINK
7	TYDB219 NA	DASH BOARD LHD		HIACE	04						
8	TYDB221 NA	DASH BOARD LHD		HIACE	04						
9	55300-26160B0	DASH BOARD		COMUTER	'04-'11	55300-26160B0					

10 FRONT FACE SHORT (LOW ROOF)



HOOD LONG (HIGH ROOF)



11 FRONT STEP PANEL



NO	CODE	DESCRIPTION	PATTERN	MODEL	YEAR	OEM	PCS	M3	N.W.	GW	PART LINK
10	TYFP219 NA	FACE PANEL W/LOGO HOLE SHORT REM		COMUTER	04-'11	53301-26080/28040(SA)					
	53301-26080	FACE PANEL W/LOGO HOLE SHORT		HIACE	04-'11	53301-26080					
	TYFP221 NA	FACE PANEL W/LOGO HOLE LONG REM		HIACE	04-'11	53301-26090					
	53301-26090	FACE PANEL W/LOGO HOLE LONG		HIACE	04-'11	53301-26090					
11	TYST221 NA	FRONT STEP PANEL		HIACE	04						

12 PANEL LOWER



13 SIDE CORNER REAR PLASTIC



14 LICENSE PLATE



NO	CODE	DESCRIPTION	PATTERN	MODEL	YEAR	OEM	PCS	M3	N.W.	GW	PART LINK
12	TYPL221 RA	PANEL LOWER RH		COMUTER	04-'11	51773-26033-B2					
	TYPL221 LA	PANEL LOWER LH		COMUTER	04-'11	51774-26033-B2					
13	TYRP221 RA	SIDE CORNER REAR PLASTIC RH		HIACE	04-'11	52165-26020					
	TYRP221 LA	SIDE CORNER REAR PLASTIC LH		HIACE	04-'11	52166-26020					
14	TYLP225 NA	LICENSE PLATE	CP/SV	VENTURY	'04-'10	75403-DX010					

TOYOTA HIACE COMUTER / QUANTUM '2004-'2010

1 HEADLAMP BRACKET



2 SILL BODY SIDE INNER LOWER R/L



3 FRONT STEP PANEL



NO	CODE	DESCRIPTION	PATTERN	MODEL	YEAR	OEM	PCS	M3	N.W.	GW	PART LINK
1	53272-26011	HEADLAMP BRACKET METAL		COMUTER	'04-'10	53272-26011					
	53271-26021	HEAD LAMP BRACKET METAL		COMUTER	'04-'10	53271-26021					
2	61132-26120	SILL BODY SIDE LOWER INNER LH		COMUTER	'04-'11	61132-26120					
	61131-26080	SILL BODY SIDE LOWER INNER RH		COMUTER	'04-'11	61131-26080					
3	61415-26020	SILL BODY SIDE OUTER PANEL RH		COMUTER	'04-'11	61415-26020					
	61416-26020	SILL BODY SIDE OUTER PANEL LH		COMUTER	'04-'11	61416-26020					

4 COWL PANEL SUB-ASSY



5 F. DOOR PILLAR SUB ASSY INNER UPPER



6 F. PILLAR REINFORCEMENT INNER LOWER



NO	CODE	DESCRIPTION	PATTERN	MODEL	YEAR	OEM	PCS	M3	N.W.	GW	PART LINK
4	55706-26050	COWL PANEL SUB-ASSY,		COMUTER	'04-'11	55706-26050					
	55705-26080	COWL PANEL SUB-ASSY,		COMUTER	'04-'11	55705-26080					
5	61024-26160	FRONT DOOR PILLAR SUB ASSY UPPER		COMUTER	'04-'11	61024-26160					
	61023-26200	FRONT DOOR PILLAR SUB ASSY UPPER		COMUTER	'04-'11	61023-26200					
6	61109-26010	F PILLAR REINFORCEMENT INNER LOWER LH		COMUTER	'04-'11	61109-26010					
	61108-26010	F PILLAR REINFORCEMENT INNER LOWER RH		COMUTER	'04-'11	61108-26010					

7 LOWER ARM



8 SIDE CORNER PANEL BK



9 SIDE CORNER PANEL CP



NO	CODE	DESCRIPTION	PATTERN	MODEL	YEAR	OEM	PCS	M3	N.W.	GW	PART LINK
7	48068-26160	LOWER ARM RH (HIGH/SHORT ROOF)		HIACE	'04-'11	48068-26160					
	48069-26160	LOWER ARM LH (HIGH/LOW ROOF)		HIACE	'04-'11	48069-26160					
8	TYCP219 RA	SIDE CORNER PANEL RH BK		COMMUTER	'04-'11	53801-26010					
	TYCP219 LA	SIDE CORNER PANEL LH BK		COMMUTER	'04-'11	53802-26020					
9	TYCP221 RA	CORNER PANEL RH CP		COMMUTER	'04-'11	53801-26010	1				
	TYCP221 LA	CORNER PANEL LH CP		COMMUTER	'04-'11	53802-26020	1				

10 FRONT SKIRT 6 PCS SETS SHORT



11 FRONT SKIRT 6 PCS SETS LONG



12 LICENSE LAMP MOULDING



NO	CODE	DESCRIPTION	PATTERN	MODEL	YEAR	OEM	PCS	M3	N.W.	GW	PART LINK
10	TYSK219 SA	FRONT SKIRT 6 PCS SETS SHORT		HIACE	08-10		1	0.1800	9.00	10.00	
11	TYSK221 SA	FRONT SKIRT 6 PCS SETS LONG		HIACE	08-10		1	0.2000	10.00	12.00	
12	TYLP221 NA	LICENSE LAMP MOULDING BK		HIACE	'04-'11	76811-26130					
	TYLP221 NB	LICENSE LAMP MOULDING CP		HIACE	'04-'11	76811-26140					

13 SUPPORT ASSY- RADIATOR /NARROW



14 RADIATOR SUPPORT/ WIDE



15 PILLAR SUB ASSY FRONT



NO	CODE	DESCRIPTION	PATTERN	MODEL	YEAR	OEM	PCS	M3	N.W.	GW	PART LINK
13	53201-26081	SUPPORT ASSY- RADIATOR /NARROW		HIACE	'04-'11	53201-26081					
14	53201-26091	RADIATOR SUPPORT/ WIDE		KDH200/HIACE	'04-'11	53201-26091					
15	61027-95J01	PILLAR SUB ASSY FRONT RH		HIACE	'04-'11	61027-95J01					
	61028-95J01	PILLAR SUB ASSY FRONT LH		HIACE	'04-'11	61028-95J01					

TOYOTA HIACE COMUTER / QUANTUM '2004-'2010

1 FRONT DOOR PILLAR FRAME OUTER **PILLST,GT BODY, OUTER** **2 FRONT DOOR OUTER FRAME LOWR ROOF**



NO	CODE	DESCRIPTION	PATTERN	MODEL	YEAR	OEM	PCS	M3	N.W.	GW	PART LINK
1	61132-26160	FRONT DOOR PILLAR FRAME OUTER LA HIGH RC	COMUTER		'04-'11	61132-26160					
	61131-26110	FRONT DOOR PILLAR FRAME OUTER RH HIGH R	COMUTER		'04-'11	61131-26110					
	61131-26111	PILLAR,FR BODY, OUTER RH	COMUTER		04-11	61131-26111					
2	61132-26140	F. DOOR PILLAR FRAME OUTER LOW ROOFLH	COMUTER		04-'11	61132-26140					
	61111-26300	F. DOOR PILLAR FRAME OUTER LOW ROOF RH	COMUTER		04-'11	61111-26300					

3 WIPER PANEL LONG **4 WIPER PANEL SHORT LHD HOLE ON LEFT** **5-6 R.BUMBER BRACKET**



NO	CODE	DESCRIPTION	PATTERN	MODEL	YEAR	OEM	PCS	M3	N.W.	GW	PART LINK
3	TYW221 NA	WIPER PANEL LONG LHD 3 PCS SET		HIACE	04-'11						
	TYW221 NB	WIPER PANEL LONG RHD 3 PCS SET		HIACE	04-'11	55708-26130					
4	TYW219 NA	WIPER PANEL SHORT LHD 3 PCS SET		HIACE	04-'11						
	TYW219 NB	WIPER PANEL SHORT RHD 3 PCS SET		HIACE	04-'11	55708-26090					
5	TYRS221 RA	REAR CONER PANEL BRACKET RH		HIACE	04-'11	52155-26150					
	TYRS221 LA	REAR CONER PANEL BRACKET LH		HIACE	04-'11	52156-26010					
6	TYBS222 RA	R.BUMBER BRACKET RH		HIACE	04-'11	52157-26010					
	TYBS222 LA	R.BUMBER BRACKET LH		HIACE	04-'11	52158-26010					

7 FRONT BUMPER BRACKET **8 F.BUMPER REINFORCE** **9 BUMPER REINFORCEMENT UPPER**



NO	CODE	DESCRIPTION	PATTERN	MODEL	YEAR	OEM	PCS	M3	N.W.	GW	PART LINK
7	TYBS221 RA	REAR BUMPER BRACKET RH		HIACE	04-'10	52115-26101					
	TYBS221 LA	REAR BUMPER BRACKET LH		HIACE	04-'10	52116-26091					
8	52131-26020	F. BUMPER REINFORCE CENTER SHORT		HIACE COMUTER	'04-'11	52131-26020					
	52131-26030	F. BUMPER REINFORCE CENTER LONG		HIACE COMUTER	'04-'11	52131-26030					
9	57053-26010	F.BUMPER REINFORCEMENT UPPER SHORT		HIACE	'04-'11	57053-26010					
	57053-26020	F.BUMPER REINFORCEMENT UPPER LONG		HIACE	'04-'11	57053-26020					
10	53827-26010	FRONT FENDER PROTECTOR		COMUTER	'04-'11	53827-26010					

11 PANEL C/MBR **12 AIR CLEANER GASOLINE WITH HOLE** **13 AIR CLEANER GASOLINE**



NO	CODE	DESCRIPTION	PATTERN	MODEL	YEAR	OEM	PCS	M3	N.W.	GW	PART LINK
11	57109-26040	PANEL C/MBR		HIACE	04-11	57109-26040					
12	TYAH219 NA	AIR CLEANER GASOLINE		COMMUTER	04-'11						
13	TYAH221 NA	AIR CLEANER DIESEL		HIACE	04-'11	17700-30181					

14 AIR INTAKE RESONATOR GAS/DISEL **15 RADIATOR FAN SHROUD DIESEL/GASOLINE** **16 FAN ASSY W/MOTOR**



NO	CODE	DESCRIPTION	PATTERN	MODEL	YEAR	OEM	PCS	M3	N.W.	GW	PART LINK
14	TYAI221 NA	AIR INTAKE RESONATOR GAS/ DIESEL		HIACE COMUTE	04-'11	17893-30030	1	0.0100	2.00	3.00	
15	TYRF221 NA	RADIATOR FAN SHROUD DIESEL/GASOLINE		HIACE	05-09	16712-75121	1	0.04	2.00	3.00	
16	16360-75021	FAN ASSY W/O MOTOR		HIACE	04-'11	16360-75021					
	16360-75031	FAN ASSY W/MOTOR		HIACE	04-'11	16360-75031					

TOYOTA HIACE COMUTER / QUANTUM '2004-'2010

1 RADIATOR FAN GUARD TWIN

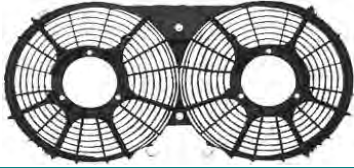

2 AIR CONDITON FAN SHOURD

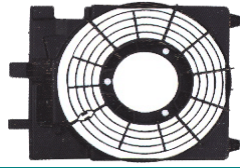

3 ENGINE FAN BLADE 5 BLADE



NO	CODE	DESCRIPTION	PATTERN	MODEL	YEAR	OEM	PCS	M3	N.W.	GW	PART LINK
1	TYRG231 NA	RADIATOR FAN GUARD TWIN		HIACE	04-11		1	0.02	1.00	1.00	
2	TYRF219 NA	AIR CONDITION FAN SHOURD		HIACE COMUTE	04-'11	16711-30050					
3	EFB221 NA	ENGINE FAN BLADE 5 BLADE		HIACE	05-09		1	0.01	1.00	1.00	

4 AIR BRACKET RESONATOR GAS/DIESEL



5 RADIATOR DIESEL MANUAL



6 CONDENSER



NO	CODE	DESCRIPTION	PATTERN	MODEL	YEAR	OEM	PCS	M3	N.W.	GW	PART LINK
4	TYBI221 NA	AIR BRACKET RESONATOR GAS/DIESEL		HIACE COMUTE	04-'11	17894-30010	1	0.0200	2.00	3.00	
5	16400-30160	RADIATOR DIESEL MANUAL		HIACE	04-'11	16400-30160					
6	PL3710	CONDENSER		COMMUTER	04-'11	PL3710					

7 DOOR MIRROR COVER CP SET



8 DOOR HANDLE COVER CP



9 HEADLIGHT COVER CP



NO	CODE	DESCRIPTION	PATTERN	MODEL	YEAR	OEM	PCS	M3	N.W.	GW	PART LINK
7	TYMC221 SB	DOOR MIRROR COVER CP SET		HIACE COMUTE	04-11						
	TYMC221 SD	DOOR MIRROR COVER WITH LED CP		HIACE COMUTE	04-11						
8	TYDH221 SB	DOOR HANDLE COVER CP		COMUTER	04-'11						
9	TYHC221 SB	HEADLIGHT COVER CP		COMUTER	04-'11						

10 EXPANSION POT DIESEL/GASOLINE



11 AIR FILTER 2KD



NO	CODE	DESCRIPTION	PATTERN	MODEL	YEAR	OEM	PCS	M3	N.W.	GW	PART LINK
10	TYTR221 NA	EXPANSION POT DIESEL/GASOLINE		HIACE COMUTE	04-'11	16470-75121	1	0.0100	1.00	1.00	
11	17801-30050	AIR FILTER 2KD		HIACE	04-'11	17801-30050					

TOYOTA HIACE COMMUTER '2010-'2011



NO	CODE	DESCRIPTION	PATTERN	MODEL	YEAR	OEM	PCS	M3	N.W.	GW	PART LINK
1	TYP231 NA	FRONT BUMPER COVER		HIACE	10-11						
	TYP232 NA	REAR BUMPER COVER		HIACE	10-11						
	TYSK231 LA	SIDE SKIRT LH		HIACE	10-11						
	TYSK231 RA	SIDE SKIRT RH		HIACE	10-11						
	TYSK231 SA	FRONT SKIRT 6 PCS SETS LONG		HIACE	10-11						



NO	CODE	DESCRIPTION	PATTERN	MODEL	YEAR	OEM	PCS	M3	N.W.	GW	PART LINK
2	TYB231 NA	F.BUMPER LONG	REM	HIACE	10-11	52119-26800	1.00	0.06	5.00	5.00	
3	TYBF231 NA	FRONT BUMPER INSERT BK (WIDE TYPE)	HIACE	10-11	53112-26050(TH)	1	0.0252	0.90	1.42		
4	TYG231 NA	GRILLE SV/BK LONG	REM	HIACE	10-11						



NO	CODE	DESCRIPTION	PATTERN	MODEL	YEAR	OEM	PCS	M3	N.W.	GW	PART LINK
5	TYG231 NB	GRILLE CP/BK	REM	HIACE	10-11	53111-26420					
6	TYG231 NG	GRILLE		HIACE	10-11						
7	TYG232 NA	GRILLE MODIFY CP/BK	REM	HIACE	10-11						



NO	CODE	DESCRIPTION	PATTERN	MODEL	YEAR	OEM	PCS	M3	N.W.	GW	PART LINK
8	TYHL231 LA	HEAD LAMP UNIT LH RHD	RHD	HIACE	10-11	81170-26580					
	TYHL231 RA	HEAD LAMP UNIT RH RHD	RHD	HIACE	10-11	81130-26580					
9	TYHL231 LB	HEAD LAMP ELECTRIC RH	RHD	HIACE	10-11	81170-26580					
	TYHL231 RB	HEAD LAMP ELECTRIC LH	RHD	HIACE	10-11	81130-26580					
10	TYFL231 RA	FOG LAMP WITH ROUND COVER RH		HIACE	10-11	81210-52052/81481-26090					
	TYFL231 LA	FOG LAMP WITH ROUND COVER LH		HIACE	10-11	81220-52052/81482-26090					

TOYOTA HIACE COMMUTER '2010-'2011

1 FOG LAMP COVER

**** NEW****

2 DOOR MIRROR

3 DOOR MIRROR W/LED ELECTRIC



NO	CODE	DESCRIPTION	PATTERN	MODEL	YEAR	OEM	PCS	M3	N.W.	GW	PART LINK
1	TYFC231 RB	FOG LAMP COVER W / HOLE RH		HIACE	10-11	81481-26070	1	0.0051	0.13	0.14	
	TYFC231 LB	FOG LAMP COVER W/ HOLE LH		HIACE	10-11	81482-26070					
2	TYMR231 LA	DOOR MIRROR LH		HIACE	10-11						
	TYMR231 RA	DOOR MIRROR RH		HIACE	10-11						
3	TYMR231 LB	DOOR MIRROR W/LED ELECTRIC LH COMMUTER			10-11						
	TYMR231 RB	DOOR MIRROR W/LED ELECTRIC RH COMMUTER			10-11						

4 FRONT BUMPER BRACKER

R/LA A

5 COVER FRONT BUMPER

6 REAR LICSESE PLATE CP



NO	CODE	DESCRIPTION	PATTERN	MODEL	YEAR	OEM	PCS	M3	N.W.	GW	PART LINK
4	TYBS231 RA	FRONT BUMPER BRACKER RH		HIACE	11-12	52116-26092	1	0.0010	0.25	0.25	
	TYBS231 LA	FRONT BUMPER BRACKER LH		HIACE	11-12	52115-26111	1	0.0010	0.25	0.25	
5	TYB231SP LA	COVER FRONT BUMPER LH		HIACE	10-12	52127-26190-A0	1	0.0010	0.25	0.25	
	TYB231SP RA	COVER FRONT BUMPER RH		HIACE	10-12	52127-26180-A0	1	0.0010	0.25	0.25	
6	TYLP231 NA	REAR LICSESE PLATE CP		HIACE	10-11						

TOYOTA HIACE COMMUTER '2010 (SHORT ROOF)



1 FRONT BUMPER



2 GRILLE SV/BK SHORT



3 GRILLE CP/BK SHORT



53111-26400

NO	CODE	DESCRIPTION	PATTERN	MODEL	YEAR	OEM	PCS	M3	N.W.	GW	PART LINK
1	TYB229 NA	FRONT BUMPER SHORT		HIACE	10-11	52119-26730(TH)					
2	TYG229 NA	GRILLE SV/BK SHORT		HIACE	10-11						
3	TYG229 NB	GRILLE CP/BK SHORT		HIACE	10-11	53111-26400					

4 GRILLE MODIFY



5 BUMPER FINISHER CENTER ****NEW****



6 FOG LAMP COVER W/O HOLW ****NEW****



NO	CODE	DESCRIPTION	PATTERN	MODEL	YEAR	53112-26050(TH)	PCS	M3	N.W.	GW	PART LINK
4	TYG230 NA	GRILLE CP/BK MODIFY		HIACE	10-11						
5	TYBF229 NA	F. BUMPER FINISHER SHORT		HIACE	10-11	53112-26040					
6	<u>TYFC231 LA</u>	FOG LAMP COVER LH W/O HOLE		HIACE	10-11	53113-26030	5	0.02	2.00	3.00	
	<u>TYFC231 RA</u>	FOG LAMP COVER RH W/O HOLE		HIACE	10-11	53112-26030	5	0.02	2.00	3.00	

7 HEAD LAMP UNIT LHD



8 HEAD LAMP UNIT LHD ELECTRIC



9 SKIRT SETS

NO	CODE	DESCRIPTION	PATTERN	MODEL	YEAR	OEM	PCS	M3	N.W.	GW	PART LINK
7	TYHL229 LA	HEAD LAMP UNIT LH	LHD	HIACE	10-11	81170-26580					
	TYHL229 RA	HEAD LAMP UNIT RH	LHD	HIACE	10-11	81130-26580					
8	TYHL229 LB	HEAD LAMP UNIT LH ELECTRIC	LHD	HIACE	10-11	81170-26580					
	TYHL229 RB	HEAD LAMP UNIT RH ELECTRIC	LHD	HIACE	10-11	81130-26580					
9	TYSK229 SA	SKIRT SETS 6 PCS		HIACE	10-11		1	0.15	10.00	12.00	